

# RESIDENCE



RESIDENCE SOHE 2008



1 108 116 gladstone street  
south melbourne streetscape



108 116 gladstone street  
south melbourne frotn view



108 116 gladstone street  
south melbourne iron fence



108 116 gladstone street  
south melbourne rear lane  
view

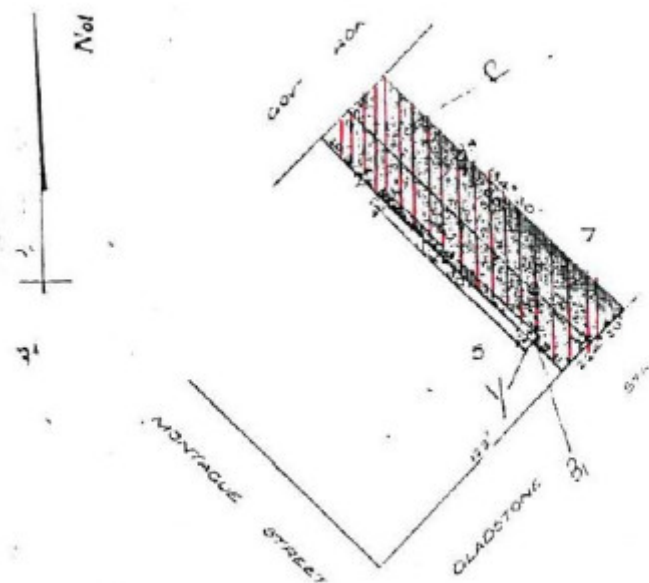

H0837 H0837 plan

---

## **Location**

114 GLADSTONE STREET SOUTHBANK, PORT PHILLIP CITY

## **Municipality**

PORT PHILLIP CITY

## **Level of significance**

Registered

## **Victorian Heritage Register (VHR) Number**

H0837

## **Heritage Overlay Numbers**

HO134

## **VHR Registration**

February 6, 1991

## **Amendment to Registration**

September 25, 1991

## **Heritage Listing**

Victorian Heritage Register

---

## **Statement of Significance**

Last updated on - February 3, 2000

The houses at 83-89 Montague and 108-116 Gladstone streets, South Melbourne are an extraordinary example of council initiated action into public housing under the provision of the Housing Reclamation Act and the site of the first attempt at slum reclamation, the only known one which occurred in the history of public housing in Victoria.

These houses, by their association with the development of public housing in Victoria, are historically important in representing the bridging between the schemes for housing offered by the state savings bank, which were dependent on the initiative of the prospective owners, and the establishment of the Housing Commission in 1938.

These houses are also of historical significance because of their probable association with J. L. Murphy, local MLA and Councillor, who played a prominent role in the history of housing in the Port area (South Melbourne and Port Melbourne).

The houses at 83-89 Montague and 108 - 116 Gladstone streets, South Melbourne are of historical significance because of their links with the port area, a centre for housing reform agitation between the early 1900's and 1930's, partly due to the strength of the Labor Party in the area.

The houses are also of historical significance in being representative of the philosophy and values of various governments which consistently advocated the ideal of home-ownership; and the gradual acceptance of responsibility for a centralised authority to provide cheap, affordable housing.

Architecturally these buildings are significant in their ability to reflect the values and philosophies which existed at the time of their construction. This is evident in the bungalow - design of these houses, which was popular with the middle- class at the time, reflective of the designer's efforts to accommodate what was perceived as the pretensions and aspirations of potential owners. The simple design of these houses, which provided "light and fresh air", also demonstrates what was perceived to be not only ideal worker's housing, but also a panacea for society's evils.

The buildings are also important as a group of houses presenting a distinctive and coherent architectural character.

## Permit Exemptions

### General Exemptions:

General exemptions apply to all places and objects included in the Victorian Heritage Register (VHR). General exemptions have been designed to allow everyday activities, maintenance and changes to your property, which don't harm its cultural heritage significance, to proceed without the need to obtain approvals under the Heritage Act 2017.

Places of worship: In some circumstances, you can alter a place of worship to accommodate religious practices without a permit, but you must [notify](#) the Executive Director of Heritage Victoria before you start the works or activities at least 20 business days before the works or activities are to commence.

Subdivision/consolidation: Permit exemptions exist for some subdivisions and consolidations. If the subdivision or consolidation is in accordance with a planning permit granted under Part 4 of the *Planning and Environment Act 1987* and the application for the planning permit was referred to the Executive Director of Heritage Victoria as a determining referral authority, a permit is not required.

Specific exemptions may also apply to your registered place or object. If applicable, these are listed below. Specific exemptions are tailored to the conservation and management needs of an individual registered place or object and set out works and activities that are exempt from the requirements of a permit. Specific exemptions prevail if they conflict with general exemptions.

Find out more about heritage permit exemptions [here](#).

Construction dates	1935,
Heritage Act Categories	Registered place,
Hermes Number	1049
Property Number	

---

## History

Associated People: Assoc.People J L MURPHY

## Extent of Registration

## AMENDMENT OF REGISTER OF HISTORIC BUILDINGS

Historic Building No. 837.

114 Gladstone Street, South Melbourne, City of South Melbourne.

Extent:

1. The building known as 114 Gladstone Street, South Melbourne.
2. All the land described in Certificate of Title Volume 7151 Folio 064, as shown in Plan 603997K, endorsed by the Chairperson, Historic Buildings Council, held by the Director, Historic Buildings Council.

[*Victoria Government Gazette* No. G37 25 September 1991 p.2678]

*This place/object may be included in the Victorian Heritage Register pursuant to the Heritage Act 2017. Check the Victorian Heritage Database, selecting 'Heritage Victoria' as the place source.*

*For further details about Heritage Overlay places, contact the relevant local council or go to Planning Schemes Online <http://planningschemes.dpcd.vic.gov.au/>*