

# ST MARYS CHURCH



ST MARYS CHURCH SOHE  
2008



1 st mary's church  
dandenong road st kilda front  
view of church

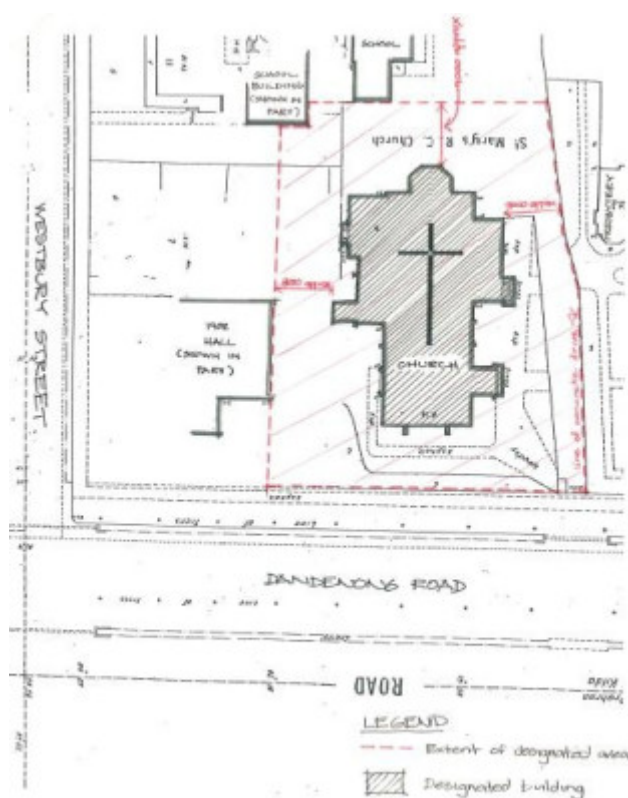

H0750 St marys

## Location

208 DANDENONG ROAD ST KILDA, PORT PHILLIP CITY

## Municipality

PORT PHILLIP CITY

## Level of significance

Registered

## Victorian Heritage Register (VHR) Number

H0750

## Heritage Overlay Numbers

HO6

## VHR Registration

November 15, 1989

## Heritage Listing

Victorian Heritage Register

---

## Statement of Significance

Last updated on - June 28, 1999

This Gothic Revival church was designed by the noted architect William Wardell (1823-1899) and built between 1859 and 1871 and forms an intact complex.

The church is of bluestone with freestone dressings. A feature of the front elevation is the dressed bluestone belfry which surmounts the composition; steep sided capping reflects that of the nave roof. The church also features raised lancet windows and steeped buttresses.

St Mary's has been described as William Wardell's most complete Australian parish church and comprises a long nave and aisles, and lopsided chancel under an unbroken roof ridge, side chapels and sacristies. The church is notable for its wealth of internal fittings.

St Mary's church is of architectural and historic importance for the following reasons:

- As one of the most important works of the noted architect William Wardell.
- As Wardell's first church in Victoria and his most complete Australian parish building.
- As an important Victorian period church in the Gothic revival manner.
- For the quality of its internal design features and detailing.

[Source: Report to the Minister]

## Permit Exemptions

### General Exemptions:

General exemptions apply to all places and objects included in the Victorian Heritage Register (VHR). General

exemptions have been designed to allow everyday activities, maintenance and changes to your property, which don't harm its cultural heritage significance, to proceed without the need to obtain approvals under the Heritage Act 2017.

**Places of worship:** In some circumstances, you can alter a place of worship to accommodate religious practices without a permit, but you must **notify** the Executive Director of Heritage Victoria before you start the works or activities at least 20 business days before the works or activities are to commence.

**Subdivision/consolidation:** Permit exemptions exist for some subdivisions and consolidations. If the subdivision or consolidation is in accordance with a planning permit granted under Part 4 of the *Planning and Environment Act 1987* and the application for the planning permit was referred to the Executive Director of Heritage Victoria as a determining referral authority, a permit is not required.

Specific exemptions may also apply to your registered place or object. If applicable, these are listed below. Specific exemptions are tailored to the conservation and management needs of an individual registered place or object and set out works and activities that are exempt from the requirements of a permit. Specific exemptions prevail if they conflict with general exemptions.

Find out more about heritage permit exemptions [here](#).

Construction dates	1859,
Architect/Designer	Wardell, William W.,
Heritage Act Categories	Registered place,
Hermes Number	1107
Property Number	

---

## History

Associated People:

## Extent of Registration

### AMENDMENT OF REGISTER OF HISTORIC BUILDINGS

Historic Building No. 750.

St Mary's Church, 208 Dandenong Road, East St Kilda.

To the extent of: St Marys Church, which is included on the land hatched in the Register Book Certificate of Title Volume 971, Folio 037 to the extent of the land hatched in Appendix A.

[*Victoria Government Gazette* No. G45 15 November 1989 p. 2950]

*This place/object may be included in the Victorian Heritage Register pursuant to the Heritage Act 2017. Check the Victorian Heritage Database, selecting 'Heritage Victoria' as the place source.*

For further details about Heritage Overlay places, contact the relevant local council or go to Planning Schemes Online <http://planningschemes.dpcd.vic.gov.au/>