

## FORMER WESLEYAN METHODIST CHURCH



FORMER WESLEYAN  
METHODIST CHURCH  
SOHE 2008



1 former wesleyan methodist  
church fitzroy street st kilda  
front view of church

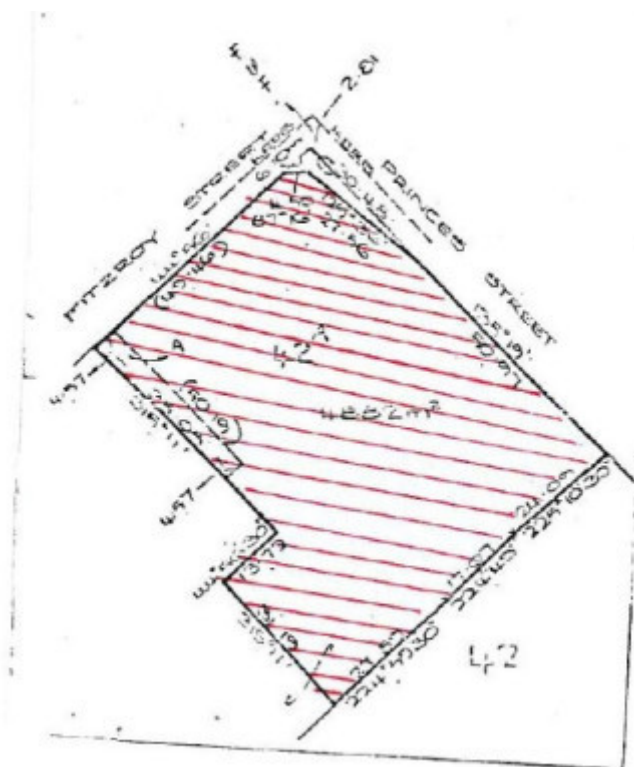

H0818 H0818 plan

### Location

167 FITZROY STREET ST KILDA, PORT PHILLIP CITY

### Municipality

## Level of significance

Registered

## Victorian Heritage Register (VHR) Number

H0818

## Heritage Overlay Numbers

HO128

## VHR Registration

September 5, 1990

## Heritage Listing

Victorian Heritage Register

---

## Statement of Significance

Last updated on - July 1, 1999

Source: Report to the Minister

### Statement of Significance

The former Wesleyan Methodist Church and 1889 manse form part of a group of buildings on the site which includes the 1857-58 church (the building on the site), the 1889 polychrome brick manse, a later 1927 manse and an 1880s hall burned out in May 1990. The 1850s church and 1889 manse have both architectural and historic significance but the other buildings on the site are regarded as of little significance.

1. The bluestone 1857-58 former Wesleyan Church has architectural significance as one of the first Wesleyan churches in Victoria designed in the gothic style with a square central entrance tower with early English stepped buttresses and pinnacles above.
2. It is significant, also, as the work of the distinguished architectural firm of Crouch & Wilson, who designed some of Victoria's most notable buildings.
3. The 1889 two-storey polychrome brick manse is significant architecturally and was probably designed by the architects Percy Oakden and Ralph Wilson.
4. The former Wesleyan Methodist church and 1889 manse have historical significance, illustrating the important role of the Wesleyan Methodists in colonial Victoria and in the early years of the present century.

[Additional information]

Source: Victorian Church Survey

The old St Kilda Methodist Church is a finely designed 1850's church building and centrepiece of a group of individually significant buildings in an urban conservation area. Towered churches from the 1850s are rare in Melbourne and this building is thus of special significance in this regard as well as for its design and detailing. This building is an important work of architects Crouch & Wilson. TJ Crouch was prominent in St Kilda Methodist

church affairs and lived locally. St Kilda was the home of many of the better off Melbournians in the 1850s, '60s and '70s. The adjacent former Sunday School is one of Melbourne's finest and the combination of fine church and hall side by side gives each added significance.

## Permit Exemptions

### General Exemptions:

General exemptions apply to all places and objects included in the Victorian Heritage Register (VHR). General exemptions have been designed to allow everyday activities, maintenance and changes to your property, which don't harm its cultural heritage significance, to proceed without the need to obtain approvals under the Heritage Act 2017.

**Places of worship:** In some circumstances, you can alter a place of worship to accommodate religious practices without a permit, but you must [notify](#) the Executive Director of Heritage Victoria before you start the works or activities at least 20 business days before the works or activities are to commence.

**Subdivision/consolidation:** Permit exemptions exist for some subdivisions and consolidations. If the subdivision or consolidation is in accordance with a planning permit granted under Part 4 of the *Planning and Environment Act 1987* and the application for the planning permit was referred to the Executive Director of Heritage Victoria as a determining referral authority, a permit is not required.

Specific exemptions may also apply to your registered place or object. If applicable, these are listed below. Specific exemptions are tailored to the conservation and management needs of an individual registered place or object and set out works and activities that are exempt from the requirements of a permit. Specific exemptions prevail if they conflict with general exemptions.

Find out more about heritage permit exemptions [here](#).

Construction dates	1857,
Architect/Designer	Crouch & Wilson,
Heritage Act Categories	Registered place,
Hermes Number	1110
Property Number	

---

## History

Associated People: Assoc.People .....

## Extent of Registration

### AMENDMENT OF REGISTER OF HISTORIC BUILDINGS

Historic Building No. 818:

The Former Wesleyan Methodist Church and 1889 Manse, 167 Fitzroy Street, St Kilda.

(The whole of the land in Certificate of Title Vol. 9521 Fol. 193 and the buildings shown hatched on the site plan held in Appendix A.)

[Victoria Government Gazette No. G35 3 September 1990 p.2699]

*This place/object may be included in the Victorian Heritage Register pursuant to the Heritage Act 2017. Check the Victorian Heritage Database, selecting 'Heritage Victoria' as the place source.*

*For further details about Heritage Overlay places, contact the relevant local council or go to Planning Schemes Online <http://planningschemes.dpcd.vic.gov.au/>*