

Dwelling and Cowan Cottage

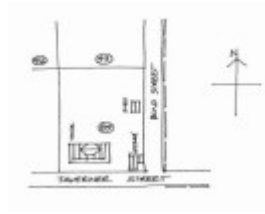

Cowan Cottage (no. 20).



Cowan Cottage (no. 20).

Location

18 Taverner Street MADDINGLEY, MOORABOOL SHIRE

Municipality

MOORABOOL SHIRE

Level of significance

Included in Heritage Overlay

Heritage Overlay Numbers

HO169

Heritage Listing

Moorabool Shire

Statement of Significance

Last updated on - June 1, 1995

What is significant?

The Farm Complex comprising the Edwardian farmhouse, corner weatherboard cottage and stables along Bond Street located at 18-20 Taverner Street, Maddingley.

How is it significant?

The Farm Complex at 18-20 Taverner Street, Maddingley is of local historical and aesthetic significance to the Shire of Moorabool.

Why is it significant?

The Farm Complex at 18-20 Taverner Street, Maddingley is of historical significance for its demonstration of the early settlement of the Maddingley area for farming purposes and the establishment of the commercial orchard industry in the area. James Cowan erected the farmhouse in 1904 and subsequently established one of the first commercial orchards in the area, in Fiske Street. The property is of historical significance for its associations with the prominent orcharding family in the Bacchus Marsh area, the Cowan family. The complex of buildings is of historical significance for demonstrating the operations of an early 20th century orchard.

The Farm Complex at 18-20 Taverner Street, Maddingley is of aesthetic significance as an excellent intact example of an early 20th century orchard complex, including a farmhouse and stables that have been converted for other uses including a fruit packing shed. The farmhouse is of architectural significance as an intact example of an Edwardian farmhouse retaining key original features, including as the double hipped frontage with decorative bargeboards, half timbering and finials, the return skillion verandah, and the chimneys with brick corncicing. The corner weatherboard cottage and the former stables along Bond Street are intact examples of early 20th century outbuildings retaining original features, such as, 12 pane sash double hung windows, weatherboard cladding, and decorative bargeboards.

1995

A characteristic Edwardian timber house, a former timber stables and another timber outbuilding built in 1904 and 1912 respectively, occupied by James Cowan, the first commercial orchardist in Bacchus Marsh.

Of local historical significance as pioneering of its type and representative of an agricultural practice of its time.

The house is also of architectural significance as a representative example of an Edwardian farmhouse, now remarkable for its location so close to the centre of Bacchus Marsh.

Heritage Study/Consultant	Moorabool - Bacchus Marsh Heritage Study 1995, Richard Peterson and Daniel Catrice, 1995;
Hermes Number	117042
Property Number	

Physical Conditions

Excellent

Intactness

1 Windows to the house have been replaced and the verandah floor replaced with a concrete slab. There is an unsympathetic brick wall with metal gates on the boundary.

2 Cottage. Altered and extended from shed to cottage. The garage and all of the verandah and fence have been added. The garage door at the side is new but the opening may be early.

SIGNIFICANT INTACT ELEMENTS:

FORM. VERANDAH. ROOF FORM. EAVES DECORATION. CHIMNEYS. WINDOWS.

Physical Description 1

1. The 1904 house is Edwardian, and timber. It has double symmetrical gables facing Taverner Street with a central entry door and a skillion verandah on three sides. The gables have decorative barges, pressed metal finials, latticed vents, timbering with roughcast and turned spindle brackets. The verandah has a rail valance. There are remnant garden elements.

2. *Cottage*. Timber with a double asymmetrical gable, gable vents and decorative barges. The right hand side is set back with a skillion verandah in the angle. There is a central entry door with 12 - paned double-hung early sashes. The turned verandah posts are aligned on the boundary with a picket fence between. The Cottage appears to have been developed from an earlier shed which may have been similar in form to 3.

3. The shed is gable roofed and parallel to Bond Street. It has decorative barges with latticed vents. The front is symmetrical with 12-paned double-hung early sashes. Centrally placed, are large vehicular doors. This, presumably is the stable.

Historical Australian Themes

Agriculture

Usage/Former Usage

USE: House

PREVIOUS USE : Orchardring farmhouse and outbuildings.

This place/object may be included in the Victorian Heritage Register pursuant to the Heritage Act 2017. Check the Victorian Heritage Database, selecting 'Heritage Victoria' as the place source.

For further details about Heritage Overlay places, contact the relevant local council or go to Planning Schemes Online <http://planningschemes.dpcd.vic.gov.au/>