

ST JOSEPHS CATHOLIC CHURCH



ST JOSEPHS CATHOLIC CHURCH SOHE 2008



1 st josephs benalla front view



st josephs benalla detail of tower jun1989



st josephs benalla exterior detail of wavy parapet



st josephs benalla north side jan1989



st josephs benalla rear entry dec1989

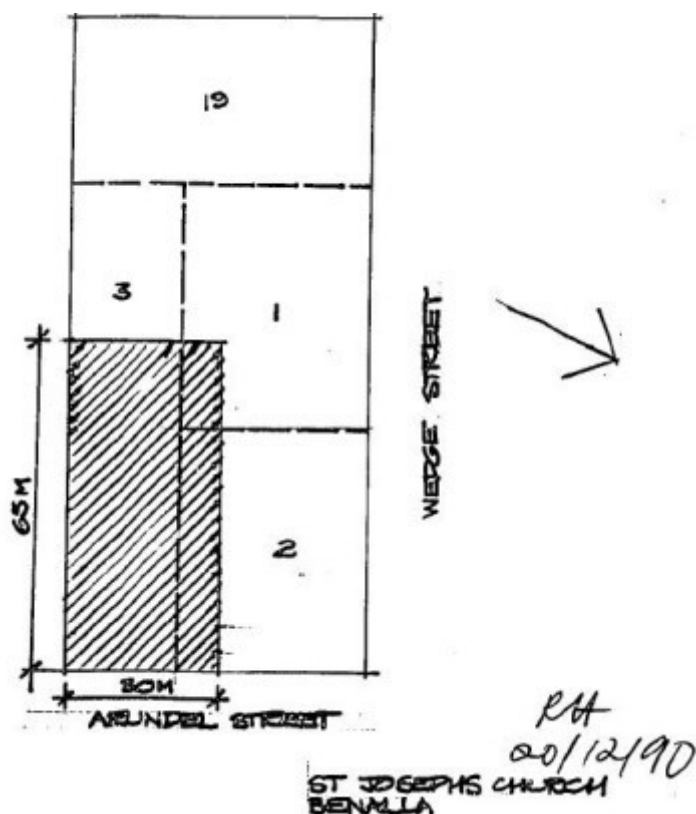

h00845 plan h0845

Location

42 ARUNDEL STREET BENALLA, BENALLA RURAL CITY

Municipality

BENALLA RURAL CITY

Level of significance

Registered

Victorian Heritage Register (VHR) Number

H0845

Heritage Overlay Numbers

HO3

VHR Registration

February 6, 1991

Heritage Listing

Victorian Heritage Register

Statement of Significance

Last updated on - July 1, 1999

St Joseph's Church at Benalla, constructed in 1907-8 to the designs of the architecture firm Kempson and Conolly, is architecturally important as an unusually large and ornate church building for country Victoria.

It is the best example of the ecclesiastical work of the firm of Kempson and Conolly, which specialised in church design. Its design in red brick, described by the architects as "Australian Romanesque", also shows Spanish Baroque influences. The 'wavy' parapet to the sides is most unusual.

It is a good example of craftsmanship with its well executed details. The original interior featured an ornate curved pressed metal ceiling painted bronze with relief work in verdigris.

Note: the pressed metal ceiling and roof were destroyed by fire in 1989; the ceiling has been replicated and the slate roof with terracotta capping has since been replaced with grey Colorbond corrugated roofing.

Permit Exemptions

General Exemptions:

General exemptions apply to all places and objects included in the Victorian Heritage Register (VHR). General exemptions have been designed to allow everyday activities, maintenance and changes to your property, which don't harm its cultural heritage significance, to proceed without the need to obtain approvals under the Heritage

Act 2017.

Places of worship: In some circumstances, you can alter a place of worship to accommodate religious practices without a permit, but you must **notify** the Executive Director of Heritage Victoria before you start the works or activities at least 20 business days before the works or activities are to commence.

Subdivision/consolidation: Permit exemptions exist for some subdivisions and consolidations. If the subdivision or consolidation is in accordance with a planning permit granted under Part 4 of the *Planning and Environment Act 1987* and the application for the planning permit was referred to the Executive Director of Heritage Victoria as a determining referral authority, a permit is not required.

Specific exemptions may also apply to your registered place or object. If applicable, these are listed below. Specific exemptions are tailored to the conservation and management needs of an individual registered place or object and set out works and activities that are exempt from the requirements of a permit. Specific exemptions prevail if they conflict with general exemptions.

Find out more about heritage permit exemptions [here](#).

Construction dates	1866,
Architect/Designer	Kempson & Conolly,
Heritage Act Categories	Registered place,
Hermes Number	122
Property Number	

History

Associated People:

Extent of Registration

AMENDMENT OF REGISTER OF HISTORIC BUILDINGS

Historic Building No. 845-

St Joseph's Catholic Church, 42 Arundel Street, Benalla.

(All the buildings (excluding the brick kiosk and toilet block) and all the land entered in the Register Book Certificate of Title Volume 3996 Folio 132, as shown hatched on Plan A endorsed by the Chairperson, Historic Buildings Council and held by the Director, Historic Buildings Council.)

[*Victoria Government Gazette* No. G5 6 February 1991 p.246]

This place/object may be included in the Victorian Heritage Register pursuant to the Heritage Act 2017. Check the Victorian Heritage Database, selecting 'Heritage Victoria' as the place source.

For further details about Heritage Overlay places, contact the relevant local council or go to Planning Schemes Online <http://planningschemes.dpcd.vic.gov.au/>