

# GEELONG COLLEGE



GEELONG COLLEGE SOHE  
2008



GEELONG COLLEGE SOHE  
2008



GEELONG COLLEGE SOHE  
2008



GEELONG COLLEGE SOHE  
2008



GEELONG COLLEGE SOHE  
2008



GEELONG COLLEGE SOHE  
2008



GEELONG COLLEGE SOHE  
2008



1 geelong college talbot  
street newtown cloisters  
nov1990

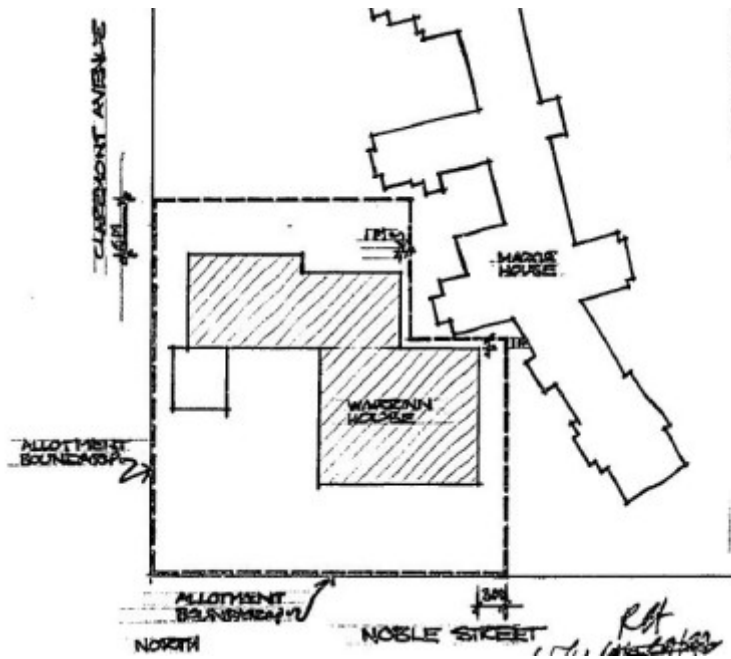

H0883 plan A

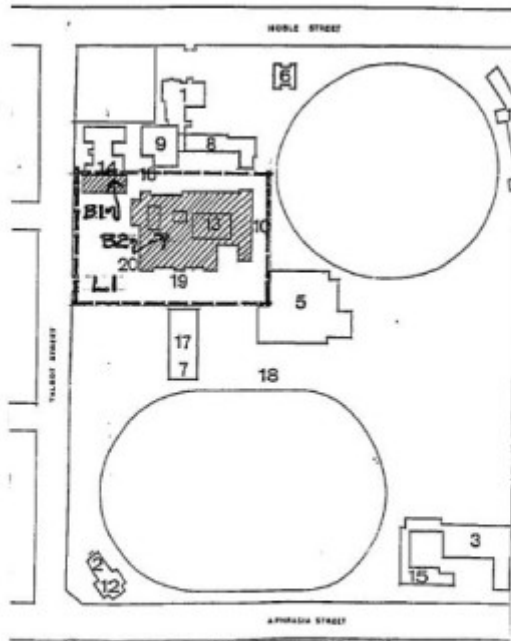

RA 15/14/2  
10/11/2

H0883 Plan B

**Location**

20 TALBOT STREET NEWTOWN, GREATER GEELONG CITY

**Municipality**

GREATER GEELONG CITY

## Level of significance

Registered

## Victorian Heritage Register (VHR) Number

H0883

## Heritage Overlay Numbers

HO141

## VHR Registration

December 2, 1993

## Heritage Listing

Victorian Heritage Register

---

## Statement of Significance

Last updated on - July 2, 1999

The Geelong College, built in 1871, is of architectural and historical significance for the following reasons:

The original building, including the 1871 Main School and its 1873 additions are excellent examples of the work of notable architects Davidson and Henderson, and are substantially intact. The 1870-73 buildings illustrate technical innovation in the early use of hollow or cavity brickwork.

The buildings designed by Philip Hudson, including the South Wing of the Main School and the Refectory (Dining Hall) are excellent examples of collegiate Tudor architecture of the 20th Century and are also intact. The Dining Hall demonstrates outstanding craftsmanship in the use of timber, particularly in the panelling and doors.

The buildings which make up the campus are visually cohesive and illustrate respect by the various architectural firms involved for the original buildings designed by Davidson and Henderson.

The buildings demonstrate the historical development of the College, which has played a significant social role, not only in the history of Geelong, but also in Victoria.

The main building, or central precinct of the school, provides evidence of the earlier influences of the school founder, George Morrison.

Warrinn House was acquired by the Geelong College in 1906. Dormitories were added in 1906, and the present form of the building illustrates the earlier relationship between the boarders and Master, together under the one roof.

## Permit Exemptions

### General Exemptions:

General exemptions apply to all places and objects included in the Victorian Heritage Register (VHR). General exemptions have been designed to allow everyday activities, maintenance and changes to your property, which

don't harm its cultural heritage significance, to proceed without the need to obtain approvals under the Heritage Act 2017.

Places of worship: In some circumstances, you can alter a place of worship to accommodate religious practices without a permit, but you must **notify** the Executive Director of Heritage Victoria before you start the works or activities at least 20 business days before the works or activities are to commence.

Subdivision/consolidation: Permit exemptions exist for some subdivisions and consolidations. If the subdivision or consolidation is in accordance with a planning permit granted under Part 4 of the *Planning and Environment Act 1987* and the application for the planning permit was referred to the Executive Director of Heritage Victoria as a determining referral authority, a permit is not required.

Specific exemptions may also apply to your registered place or object. If applicable, these are listed below. Specific exemptions are tailored to the conservation and management needs of an individual registered place or object and set out works and activities that are exempt from the requirements of a permit. Specific exemptions prevail if they conflict with general exemptions.

Find out more about heritage permit exemptions [here](#).

Construction dates	1871,
Architect/Designer	Davidson & Henderson,
Heritage Act Categories	Registered place,
Hermes Number	1937
Property Number	

---

## History

Associated People: Arch/Design: Phillip Hudson;

## Extent of Registration

### AMENDMENT OF REGISTER OF HISTORIC BUILDINGS

Historic Building No. 883-

The Geelong College

Talbot Street, Newtown.

(To the extent of:

1. The Dining Hall, contained with the building known as the Refectory Block (B1), the whole Main Building Complex which contains the original building and entrance, together with the War Memorial Wing, the Cloisters, and all other sections (B2), Geelong College, shown hatched on the attached Plan 6010501(A) endorsed by the Chairperson, Historic Buildings Council and held by the Director, Historic Buildings Council.
2. The building known as Warrinn House (B3), Geelong College shown on the attached Plan 6010501(B) endorsed by the Chairperson, Historic Buildings Council and held by the Director, Historic Buildings Council.
3. The land (L1) being part of the land entered in Certificate of Title Volume 3267 Folio 370 as shown on the attached Plan 6010501(A) endorsed by the Chairperson, Historic Buildings Council and held by the Director, Historic Buildings Council.
4. The land (L2) being part of the land entered in Certificate of Title Volume 3398 Folio 568 as shown on the attached Plan 6010501(B) endorsed by the Chairperson, Historic Buildings Council and held by the Director, Historic Buildings Council.)

[Victoria Government Gazette No. G47 2 December 1993 p.3225]

*This place/object may be included in the Victorian Heritage Register pursuant to the Heritage Act 2017. Check the Victorian Heritage Database, selecting 'Heritage Victoria' as the place source.*

*For further details about Heritage Overlay places, contact the relevant local council or go to Planning Schemes Online <http://planningschemes.dpcd.vic.gov.au/>*