

# ST ANDREWS UNITING CHURCH



ST ANDREWS UNITING  
CHURCH SOHE 2008



1 st andrews echuca front  
view feb1983

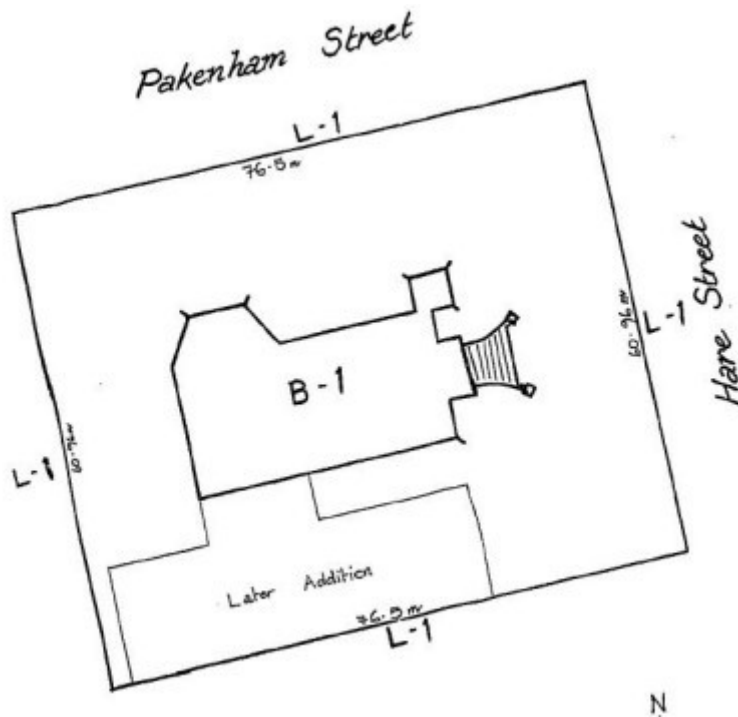

h01057 plan h1057

## Location

115-117 HARE STREET ECHUCA, CAMPASPE SHIRE

## Municipality

CAMPASPE SHIRE

## Level of significance

Registered

## Victorian Heritage Register (VHR) Number

H1057

## Heritage Overlay Numbers

HO10

## VHR Registration

November 10, 1994

## Heritage Listing

Victorian Heritage Register

---

## Statement of Significance

Last updated on - November 25, 1996

St Andrew's Uniting Church was built as a Presbyterian church in 1901 by contractors Mc Bride and Nicholls to a design by Echuca architect and engineer, Arthur Edgar Castles.

The church has architectural and historic significance to Victoria.

The church is an extraordinary and strikingly picturesque example of an Edwardian Gothic Revival church. Its boldly expressed design comprises a number of distinctive elements, including the elevation of the nave above the Sunday school and the impressive flight of slate stairs leading to the nave, featuring curving cast element balustrades and cast iron lamps; the stepped buttresses; the machicolated and castellated parapet of the tower; the steep and ornamentally slated octagonal spire; and the glazed tilework.

The church has a number of features demonstrating outstanding decoration and craftsmanship including the use of glazed tilework, the ornamental spire and tower and the corbel stepping of the gables.

The building has an association with the Rev. J C Johnstone, minister at Echuca from 1871 to 1901, who was the main driving force behind its construction. Rev. Johnstone was greatly involved in the public life of Echuca, in particular with the formation of a number of benevolent and social societies and the establishment of the local hospital. He was also an important figure in church affairs, being moderator of the Bendigo and Maryborough Presbyteries and, in 1901, being elected moderator of the Presbyterian Church of Victoria.

## Permit Exemptions

### General Exemptions:

General exemptions apply to all places and objects included in the Victorian Heritage Register (VHR). General exemptions have been designed to allow everyday activities, maintenance and changes to your property, which don't harm its cultural heritage significance, to proceed without the need to obtain approvals under the Heritage Act 2017.

Places of worship: In some circumstances, you can alter a place of worship to accommodate religious practices without a permit, but you must **notify** the Executive Director of Heritage Victoria before you start the works or activities at least 20 business days before the works or activities are to commence.

Subdivision/consolidation: Permit exemptions exist for some subdivisions and consolidations. If the subdivision or consolidation is in accordance with a planning permit granted under Part 4 of the *Planning and Environment Act 1987* and the application for the planning permit was referred to the Executive Director of Heritage Victoria as a determining referral authority, a permit is not required.

Specific exemptions may also apply to your registered place or object. If applicable, these are listed below. Specific exemptions are tailored to the conservation and management needs of an individual registered place or object and set out works and activities that are exempt from the requirements of a permit. Specific exemptions prevail if they conflict with general exemptions.

Find out more about heritage permit exemptions [here](#).

|                         |                        |
|-------------------------|------------------------|
| Construction dates      | 1901,                  |
| Architect/Designer      | Castles, Arthur Edgar, |
| Heritage Act Categories | Registered place,      |
| Hermes Number           | 2499                   |
| Property Number         |                        |

---

## History

Associated People: Assoc.People Rev JC Johnstone

## Extent of Registration

### AMENDMENT OF REGISTER OF HISTORIC BUILDINGS

Historic Building No. 1057.

St Andrew's Uniting Church, former Presbyterian Church, 115-117 Hare Street, Echuca.

(To the extent of:

1. All of the building known as St Andrew's Uniting Church, Echuca, excluding the later additions, marked B-1 on Plan 602358 endorsed by the Chairperson, Historic Buildings Council and held by the Director, Historic Buildings Council.

2. All of the land described in Certificate of Title Volume 2760 Folio 903 marked L-1 on Plan 602358 endorsed by the Chairperson, Historic Buildings Council and held by the Director, Historic Buildings Council.)

[*Victoria Government Gazette* No. G45 10 November 1994 pp.3007-3008]

*This place/object may be included in the Victorian Heritage Register pursuant to the Heritage Act 2017. Check the Victorian Heritage Database, selecting 'Heritage Victoria' as the place source.*

*For further details about Heritage Overlay places, contact the relevant local council or go to Planning Schemes Online <http://planningschemes.dpcd.vic.gov.au/>*