

## FORMER STATE SAVINGS BANK



FORMER STATE SAVINGS  
BANK SOHE 2008



h00580 former state savings  
bank h0580

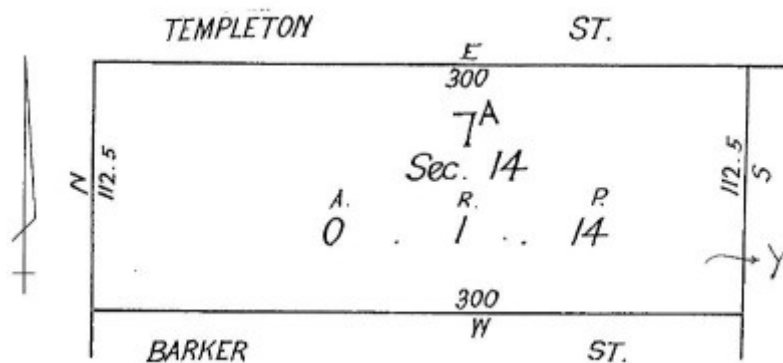

title plan 5316/007 (measurements in links 1 link = .201m)

### Location

220 BARKER STREET CASTLEMAINE, MOUNT ALEXANDER SHIRE

### Municipality

MOUNT ALEXANDER SHIRE

### Level of significance

Registered

### Victorian Heritage Register (VHR) Number

H0580

### Heritage Overlay Numbers

## VHR Registration

August 29, 1984

## Heritage Listing

Victorian Heritage Register

---

## Statement of Significance

Last updated on - June 22, 1999

The former State Savings Bank was erected in 1919 to a design by Godfrey & S Powers. The building incorporated the original government sub-treasury and police court (built 1862). Parts of these buildings remain at the rear. The single-storey bank is constructed of rendered brick on a granite plinth. It is an early example of the austere classicism of the 1920s and 1930s in its use of giant orders, cubic volumes and a heavy and abstracted parapet. The Doric pilasters are of polished granite with bronze capitals and bases. The interior of the banking chamber is tall in its proportion and has a coved and coffered ceiling (now hidden by a false ceiling) the walls are ruled in an ashlar pattern. The vaults remain but not the furniture. With the exception of paint colours, the exterior of the building and the interior of the banking chamber are intact. The building is of significance as a progenitor of a style greatly used for commercial buildings in the 1920s and 30s and which featured prominently in the later work of Godfrey and S Powers.

[Source: Report to the Minister]

## Permit Exemptions

### General Exemptions:

General exemptions apply to all places and objects included in the Victorian Heritage Register (VHR). General exemptions have been designed to allow everyday activities, maintenance and changes to your property, which don't harm its cultural heritage significance, to proceed without the need to obtain approvals under the Heritage Act 2017.

**Places of worship:** In some circumstances, you can alter a place of worship to accommodate religious practices without a permit, but you must [notify](#) the Executive Director of Heritage Victoria before you start the works or activities at least 20 business days before the works or activities are to commence.

**Subdivision/consolidation:** Permit exemptions exist for some subdivisions and consolidations. If the subdivision or consolidation is in accordance with a planning permit granted under Part 4 of the *Planning and Environment Act 1987* and the application for the planning permit was referred to the Executive Director of Heritage Victoria as a determining referral authority, a permit is not required.

Specific exemptions may also apply to your registered place or object. If applicable, these are listed below. Specific exemptions are tailored to the conservation and management needs of an individual registered place or object and set out works and activities that are exempt from the requirements of a permit. Specific exemptions prevail if they conflict with general exemptions.

Find out more about heritage permit exemptions [here](#).

Construction dates	1919,
Architect/Designer	Spowers, Godfrey,
Heritage Act Categories	Registered place,
Hermes Number	253
Property Number	

---

## History

Note that newspaper reports indicate that the Gold Office and Sub-Treasury was erected in Barker Street in c.1856. (eg. Mount Alexander Mail, 17 October 1856, p. 4.)

## Extent of Registration

### AMENDMENT OF REGISTER OF HISTORIC BUILDINGS

Historic Building No. 580, Former State Savings Bank, 220 Barker Street, Castlemaine (to the extent of all the buildings and land entered in the register book as Vol. 5316 Folio 007).  
[*Victoria Government Gazette* No. 91 29 August 1984 p. 2983]

*This place/object may be included in the Victorian Heritage Register pursuant to the Heritage Act 2017. Check the Victorian Heritage Database, selecting 'Heritage Victoria' as the place source.*

*For further details about Heritage Overlay places, contact the relevant local council or go to Planning Schemes Online <http://planningschemes.dpcd.vic.gov.au/>*