

RESIDENCE

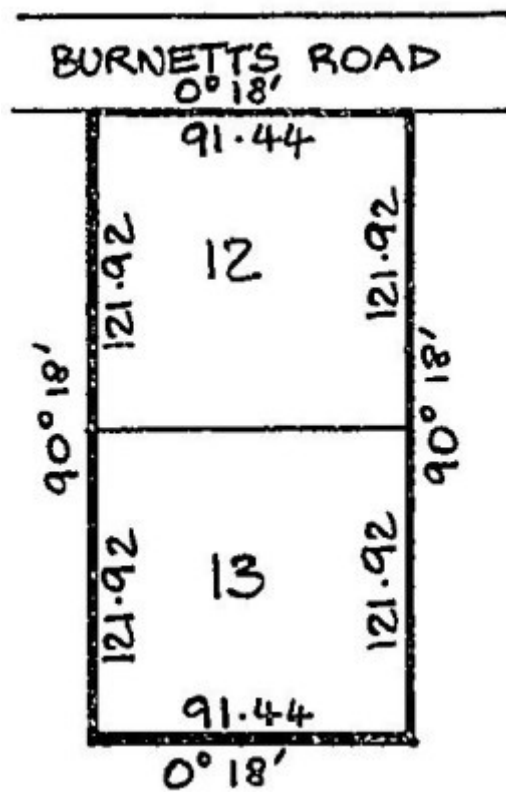

RESIDENCE SOHE 2008

1 residence burnet road
castlemaine front view
jul1981residence burnet road
castlemaine rear view jul1981

h00571 plan h0571

Location

3-5 BURNETT ROAD CASTLEMAINE, MOUNT ALEXANDER SHIRE

Municipality

Level of significance

Registered

Victorian Heritage Register (VHR) Number

H0571

Heritage Overlay Numbers

HO588

VHR Registration

May 2, 1984

Heritage Listing

Victorian Heritage Register

Statement of Significance

Last updated on - June 22, 1999

The house was built for William Froomes Jnr, a draper, in 1867. The building and/or architect is/are not known. Froomes was born at Hounslow England in 1830 and was apprenticed to a draper in London. He migrated to Adelaide and took up work with a draper Carrington Smedley at Burra Burra. Following the discovery of gold, Smedley sent Froomes to establish an outlet in Castlemaine. His first shop was in a "canvas and iron structure" on the corner of Barker and Mostyn streets, now known as Froome's corner. In 1853, Froomes purchased the business and land from Smedley and commenced a family business with his father and, later, his brother Henry. Failing eyesight forced him to retire and by 1867 he was totally blind. In this year he built his residence at Burnett road, on land he had acquired ten years previously. Froomes had been a JP, a member of local governing bodies, including chairmanship of the borough council for three terms, active on the governing bodies of many local trusts and, had the distinction of playing cricket against the first England Eleven. He died in 1873 in East Melbourne.

The house remained in his wife's name until after 1910. From 1886 it was tenanted to JW Lawson, Presbyterian minister, and his family during this time. Lawson was the father of HSW Lawson, Premier of Victoria, 1918-24.

The house is constructed of face brick with cement dressings and a corrugated iron roof. Symmetrically planned, it has a simple encircling parapet with two urns placed over the main entrance and a very elegant Regency-style verandah. The verandah has timber open-work supports and is clad with corrugated iron. The house is picturesquely located, set deeply into its wooded garden with a long drive to its main entrance.

This house is a late example of Regency architecture, and has connections with an important and early resident of Castlemaine.

[Historic Buildings Council]

Permit Exemptions

General Exemptions:

General exemptions apply to all places and objects included in the Victorian Heritage Register (VHR). General exemptions have been designed to allow everyday activities, maintenance and changes to your property, which don't harm its cultural heritage significance, to proceed without the need to obtain approvals under the Heritage Act 2017.

Places of worship: In some circumstances, you can alter a place of worship to accommodate religious practices without a permit, but you must **notify** the Executive Director of Heritage Victoria before you start the works or activities at least 20 business days before the works or activities are to commence.

Subdivision/consolidation: Permit exemptions exist for some subdivisions and consolidations. If the subdivision or consolidation is in accordance with a planning permit granted under Part 4 of the *Planning and Environment Act 1987* and the application for the planning permit was referred to the Executive Director of Heritage Victoria as a determining referral authority, a permit is not required.

Specific exemptions may also apply to your registered place or object. If applicable, these are listed below. Specific exemptions are tailored to the conservation and management needs of an individual registered place or object and set out works and activities that are exempt from the requirements of a permit. Specific exemptions prevail if they conflict with general exemptions.

Find out more about heritage permit exemptions [here](#).

Construction dates	1867,
Heritage Act Categories	Registered place,
Hermes Number	255
Property Number	

Extent of Registration

AMENDMENT OF REGISTER OF HISTORIC BUILDINGS

Historic Building No. 571, Residence, 2 Burnetts Road, Castlemaine (to the extent of the total buildings and land entered in the Register Book as Volume 9029 Folio 931).

[*Victoria Government Gazette* No. 52 2 May 1984 p. 1344]

This place/object may be included in the Victorian Heritage Register pursuant to the Heritage Act 2017. Check the Victorian Heritage Database, selecting 'Heritage Victoria' as the place source.

For further details about Heritage Overlay places, contact the relevant local council or go to Planning Schemes Online <http://planningschemes.dpcd.vic.gov.au/>