

FORMER CASTLEMAINE GAOL



FORMER HM PRISON
SOHE 2008



FORMER HM PRISON
SOHE 2008



1 former hm prison challis
street castlemaine cell block
entrance aug1984



former hm prison challis
street castlemaine centre of
cell block



former hm prison challis
street castlemaine forecourt
& administration building
dec1992



former hm prison challis
street castlemaine govorners
rsidence jan1996



former hm prison challis
street castlemaine industry
building jan1996



former hm prison challis
street castlemaine interior
corridor dec1992



former hm prison challis
street castlemaine rear view
of cell block



former hm prison challis
street castlemaine watch
tower & walls aug1984



facade conservation as at 25May2011 005.jpg

REPORT TO MINISTER PLAN NO. 6021121

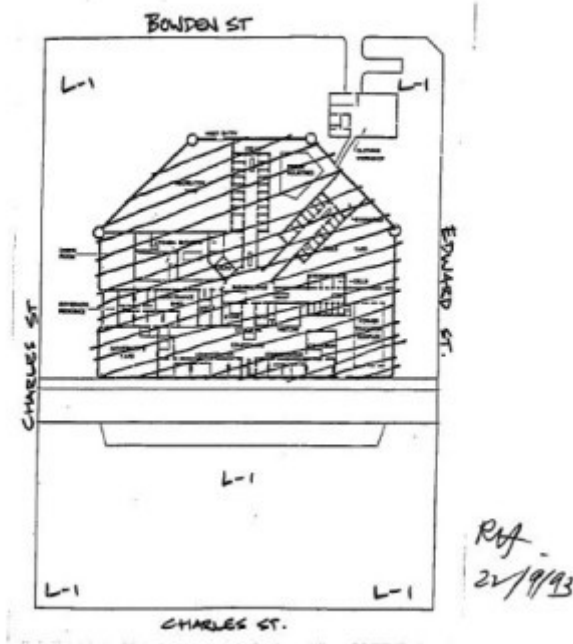

H0990 plan

Location

36-48 BOWDEN STREET CASTLEMAINE, MOUNT ALEXANDER SHIRE

Municipality

MOUNT ALEXANDER SHIRE

Level of significance

Registered

Victorian Heritage Register (VHR) Number

H0990

Heritage Overlay Numbers

HO600

VHR Registration

August 20, 1982

Amendment to Registration

October 28, 1993

Heritage Listing

Victorian Heritage Register

Statement of Significance

Last updated on - August 18, 1993

HM Prison, Castlemaine was constructed of local sandstone between 1857 and 1861. It represents an important phase in the development of prison design associated with the completion of the Model Prison at Pentonville in 1842. The influence of the Pentonville plan is evident in the radial wings, central hall and exercise yard (industries building) of Castlemaine Gaol. Beechworth, Bendigo and Castlemaine were the most accurate representations in Victoria of Jebb's panopticon design.

The completion of the Castlemaine Gaol in 1861 represents an important phase of prison construction in Victoria. Between 1857 and 1864 a remarkable period of building activity saw eight prisons constructed on Pentonville principles in metropolitan and regional areas.

The HM Prison Castlemaine is an essentially intact example of a building type. The sequence of alterations, however, is of historical importance, representing the changing requirements of prison design and construction.

The H M Prison at Castlemaine is historically significant because of its ability to represent the size and status of this town which reached pre-eminence in the second half of the nineteenth century as a result of the discovery of gold.

Permit Exemptions

General Exemptions:

General exemptions apply to all places and objects included in the Victorian Heritage Register (VHR). General exemptions have been designed to allow everyday activities, maintenance and changes to your property, which

don't harm its cultural heritage significance, to proceed without the need to obtain approvals under the Heritage Act 2017.

Places of worship: In some circumstances, you can alter a place of worship to accommodate religious practices without a permit, but you must **notify** the Executive Director of Heritage Victoria before you start the works or activities at least 20 business days before the works or activities are to commence.

Subdivision/consolidation: Permit exemptions exist for some subdivisions and consolidations. If the subdivision or consolidation is in accordance with a planning permit granted under Part 4 of the *Planning and Environment Act 1987* and the application for the planning permit was referred to the Executive Director of Heritage Victoria as a determining referral authority, a permit is not required.

Specific exemptions may also apply to your registered place or object. If applicable, these are listed below. Specific exemptions are tailored to the conservation and management needs of an individual registered place or object and set out works and activities that are exempt from the requirements of a permit. Specific exemptions prevail if they conflict with general exemptions.

Find out more about heritage permit exemptions [here](#).

Construction dates	1857,
Architect/Designer	Vickers, Charles,
Heritage Act Categories	Registered place,
Other Names	OLD CASTLEMAINE GAOL, FORMER HM PRISON,
Hermes Number	256
Property Number	

Plaque Citation

Castlemaine Gaol is registered by Heritage Council Victoria

Based on the Pentonville prison model, this austere complex was constructed in 1857-1861 using locally quarried sandstone and Harcourt granite. It was built during a remarkable period in Victorian prison construction when eight prisons were built between 1857-1864.

Extent of Registration

AMENDMENT OF REGISTER OF HISTORIC BUILDINGS

Historic Building No. 990

Former HM Prison

Gaol Hill, Castlemaine

(To the extent of:

1. all the gaol buildings, known as HM Prison, Castlemaine, hatched on Plan No. 602112J endorsed by the Chairperson, Historic Buildings Council and held by the Director, Historic Buildings Council, excluding the clothing workshop and buildings outside the original wall; and
2. all of the land marked L-1 on Plan No. 602112J endorsed by the Chairperson, Historic Buildings Council and held by the Director, Historic Buildings Council, being all of the land bounded by Edward, Bowden and Charles Streets.)

[Victoria Government Gazette No. G42 28 October 1993 p.2931]

This place/object may be included in the Victorian Heritage Register pursuant to the Heritage Act 2017. Check the Victorian Heritage Database, selecting 'Heritage Victoria' as the place source.

For further details about Heritage Overlay places, contact the relevant local council or go to Planning Schemes Online <http://planningschemes.dpcd.vic.gov.au/>