

FORMER PROTESTANT ORPHAN ASYLUM AND COMMON SCHOOL



FORMER PROTESTANT ORPHAN ASYLUM AND COMMON SCHOOL SOHE 2008



FORMER PROTESTANT ORPHAN ASYLUM AND COMMON SCHOOL SOHE 2008



FORMER PROTESTANT ORPHAN ASYLUM AND COMMON SCHOOL SOHE 2008



FORMER PROTESTANT ORPHAN ASYLUM AND COMMON SCHOOL SOHE 2008



1 former protestant orphan asylum & common school herne hill front view of asylum

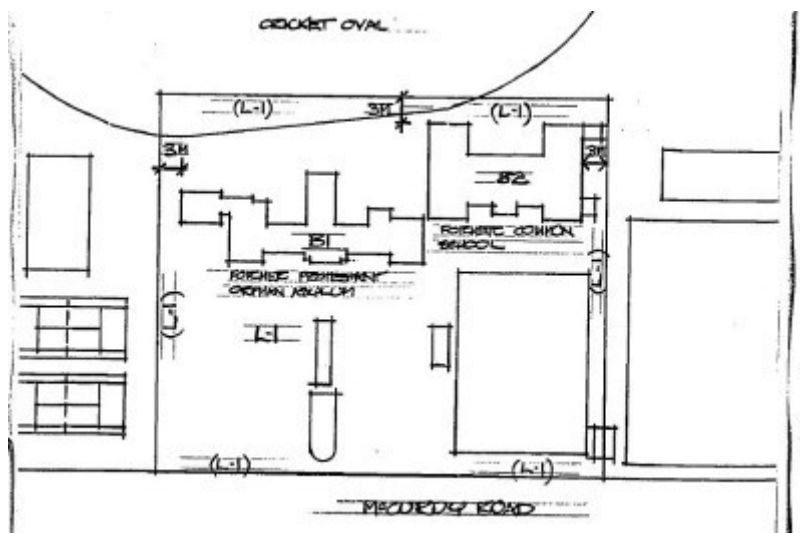

h01095 plan h1095

Location

150-220 MCCURDY ROAD FYANSFORD, GREATER GEELONG CITY

Municipality

GREATER GEELONG CITY

Level of significance

Registered

Victorian Heritage Register (VHR) Number

H1095

Heritage Overlay Numbers

HO239

VHR Registration

January 25, 1996

Heritage Listing

Victorian Heritage Register

Statement of Significance

Last updated on - May 5, 1999

What is significant?

Following a local campaign to raise funds for the construction of an orphan asylum, the former Protestant Orphan Asylum was built in 1855 as a result of an architectural competition to the designs of Geelong architect Andrew McWilliams on land granted by the government. The north wing was added in 1857. In 1865 the Common School was constructed to a design by architect Joseph Lowe Shaw. Both buildings are constructed of basalt with freestone dressings in the picturesque Gothic style. The complex was bought by Australian Portland Cement Company Limited following the removal of the Orphanage to another site at Belmont in 1933.

How is it significant?

The former Orphan Asylum and Common School are architecturally, historically and socially significant to the state of Victoria.

Why is it significant?

The former Orphanage Asylum and Common School are historically significant at a state level through their association with the history of child welfare and education in Victoria. The complex is of social significance as evidence of the social conditions in nineteenth century Victoria and demonstrates the extent of poverty in a large regional centre.

The former Orphanage, as one of the first four orphanages set up in Victoria during the 1850s, is of considerable historical and social importance. It illustrates the extent of child destitution in Victoria during the nineteenth

century and the attempts by the government and individuals to deal with the problem of destitute and neglected children.

The former Common School, a significant element of the complex, is historically important for its associations with the early history of education in Victoria. It was set up under the Common Schools Act, enacted in 1862 in an attempt to reduce denominational influence and amalgamate schools established under the National and Denominational Boards.

The former Protestant Orphan Asylum is of architectural interest as an extraordinary example of the work of early Geelong architect Andrew McWilliams, and was the winning entry in a competition for the design of the building.

The complex is of historical interest through its association with the Australian Portland Cement Company Limited (now known as Geelong Cement) formed on 30 October 1889 with shareholders from Geelong and Melbourne. The company established the first cement works in Australia on the Moorabool River flats at Fyans ford which had limited success until the First World War when the need for concrete increased and overseas supplies ceased.

Permit Exemptions

General Exemptions:

General exemptions apply to all places and objects included in the Victorian Heritage Register (VHR). General exemptions have been designed to allow everyday activities, maintenance and changes to your property, which don't harm its cultural heritage significance, to proceed without the need to obtain approvals under the Heritage Act 2017.

Places of worship: In some circumstances, you can alter a place of worship to accommodate religious practices without a permit, but you must **notify** the Executive Director of Heritage Victoria before you start the works or activities at least 20 business days before the works or activities are to commence.

Subdivision/consolidation: Permit exemptions exist for some subdivisions and consolidations. If the subdivision or consolidation is in accordance with a planning permit granted under Part 4 of the *Planning and Environment Act 1987* and the application for the planning permit was referred to the Executive Director of Heritage Victoria as a determining referral authority, a permit is not required.

Specific exemptions may also apply to your registered place or object. If applicable, these are listed below. Specific exemptions are tailored to the conservation and management needs of an individual registered place or object and set out works and activities that are exempt from the requirements of a permit. Specific exemptions prevail if they conflict with general exemptions.

Find out more about heritage permit exemptions [here](#).

Construction dates	1855,
Architect/Designer	McWilliams, Andrew,
Heritage Act Categories	Registered place,
Other Names	ORPHANAGE,
Hermes Number	2796
Property Number	

Extent of Registration

AMENDMENT OF REGISTER OF HISTORIC BUILDINGS

Historic Building No. 1095.

Former Protestant Orphan Asylum & Common School, McCurdy Road, Geelong, City of Greater Geelong.

Extent::

1. All of the buildings known as the former Protestant Orphan Asylum and Common School marked B-1 and B-2 on Plan 603091 endorsed by the Chairperson, Historic Buildings Council and held by the Director, Historic Buildings Council.
2. All of the land marked L-1 on Plan 603091 being part of the land described in Certificate of Title Volume 6022 Folio 388 endorsed by the Chairperson, Historic Buildings Council and held by the Director, Historic Buildings Council.

[*Victoria Government Gazette* No. G3 25 January 1996 pp.219-220]

This place/object may be included in the Victorian Heritage Register pursuant to the Heritage Act 2017. Check the Victorian Heritage Database, selecting 'Heritage Victoria' as the place source.

For further details about Heritage Overlay places, contact the relevant local council or go to Planning Schemes Online <http://planningschemes.dpcd.vic.gov.au/>