

BARWON BANK



h00425 1 barwon bank
riversdale road marnock vale
newtown south west cnr she
project 2004



barwon bank riversdale road
marnock vale newtown west
elevations she project 2004



barwon bank riversdale road
marnock vale newtown bay
windows she project 2004



barwon bank riversdale road
marnock vale newtown
kitchen wing she project 2004



barwon bank riversdale road
marnock vale newtown north
east cnr she project 2004



barwon bank riversdale road
marnock vale newtown south
east cnr she project 2004



barwon bank riversdale road
marnock vale newtown
sunroom she project 2004



Barwon Park Riversdale Rd
Marnock Vale Newtown Front
View Sep 1977



Barwon Bank Riversdale Rd
Marnock Vale Newtown
Additions 1997



Barwon Bank Riversdale Rd
Marnock Vale Newtown Front
Entrance Sep 1977



Barwon Bank Riversdale Rd
Marnock Vale Newtown
Kitchen Wing Sep 1977

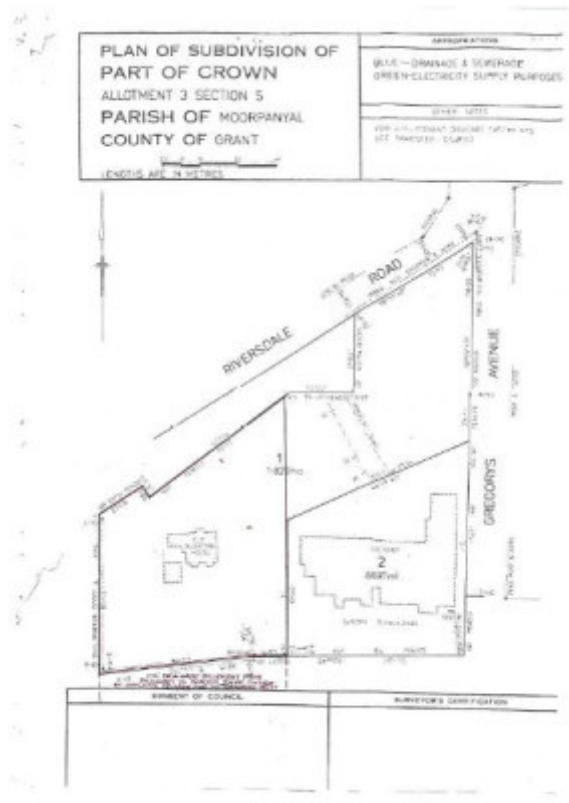

H0425 h0425 plan

Location

35-43 RIVERSDALE ROAD NEWTOWN, GREATER GEELONG CITY

Municipality

GREATER GEELONG CITY

Level of significance

Registered

Victorian Heritage Register (VHR) Number

H0425

Heritage Overlay Numbers

HO107

VHR Registration

December 14, 1977

Heritage Listing

Statement of Significance

Last updated on - June 11, 1999

Between the years 1853-1856, Geelong solicitor John Alexander Gregory built the 18 room stone mansion 'Barwon Bank' in extensive gardens on the high northern bank overlooking the Barwon River at Marnockvale, Geelong. TR Yabsley was the architect for this colonial regency style single storey attic house, built of basalt with contrasting Barrabool freestone dressings and dominated by a massive Doric portico and battlemented bay windows.

'Barwon bank' is an important early Victorian mansion house and one of few documented works in Victoria of the virtually unknown, but accomplished architect Thomas R Yabsley. Upon completion in 1856, this comparatively rare example of the colonial regency style mansion in Victoria was considered to be "the finest specimen of architecture in the western district". John Gregory, a noted Geelong solicitor occupied the mansion only until 1856, later occupants were associated with Barwon River industries.

source:

Register of the National Estate Citation

Permit Exemptions

General Exemptions:

General exemptions apply to all places and objects included in the Victorian Heritage Register (VHR). General exemptions have been designed to allow everyday activities, maintenance and changes to your property, which don't harm its cultural heritage significance, to proceed without the need to obtain approvals under the Heritage Act 2017.

Places of worship: In some circumstances, you can alter a place of worship to accommodate religious practices without a permit, but you must **notify** the Executive Director of Heritage Victoria before you start the works or activities at least 20 business days before the works or activities are to commence.

Subdivision/consolidation: Permit exemptions exist for some subdivisions and consolidations. If the subdivision or consolidation is in accordance with a planning permit granted under Part 4 of the *Planning and Environment Act 1987* and the application for the planning permit was referred to the Executive Director of Heritage Victoria as a determining referral authority, a permit is not required.

Specific exemptions may also apply to your registered place or object. If applicable, these are listed below. Specific exemptions are tailored to the conservation and management needs of an individual registered place or object and set out works and activities that are exempt from the requirements of a permit. Specific exemptions prevail if they conflict with general exemptions.

Find out more about heritage permit exemptions [here](#).

Construction dates	1856,
Architect/Designer	Yabsley, Thomas R,

Heritage Act Categories Registered place,

Hermes Number 2934

Property Number

Extent of Registration

No. 425. Barwon Bank (to the extent of the buildings and area of land within and defined by the red line indicated on the plan held at the office of the Historic Buildings Preservation Council), Riversdale Road, Marnock Vale (Chilwell), Newtown, Geelong.

[*Victoria Government Gazette* No.110 December 14, 1977 p.3911]

This place/object may be included in the Victorian Heritage Register pursuant to the Heritage Act 2017. Check the Victorian Heritage Database, selecting 'Heritage Victoria' as the place source.

For further details about Heritage Overlay places, contact the relevant local council or go to Planning Schemes Online <http://planningschemes.dpcd.vic.gov.au/>