

## AUBURN UNITING CHURCH COMPLEX



AUBURN UNITING CHURCH  
COMPLEX SOHE 2008



AUBURN UNITING CHURCH  
COMPLEX SOHE 2008



AUBURN UNITING CHURCH  
COMPLEX SOHE 2008



AUBURN UNITING CHURCH  
COMPLEX SOHE 2008



AUBURN UNITING CHURCH  
COMPLEX SOHE 2008



AUBURN UNITING CHURCH  
COMPLEX SOHE 2008



AUBURN UNITING CHURCH  
COMPLEX SOHE 2008



h02034 uniting church auburn  
h2034



h02034 uniting church auburn  
sunday school



h02034 uniting church auburn  
manse



h02034 uniting church auburn  
interior and organ



h02034 uniting church auburn h2034 extent april 2003

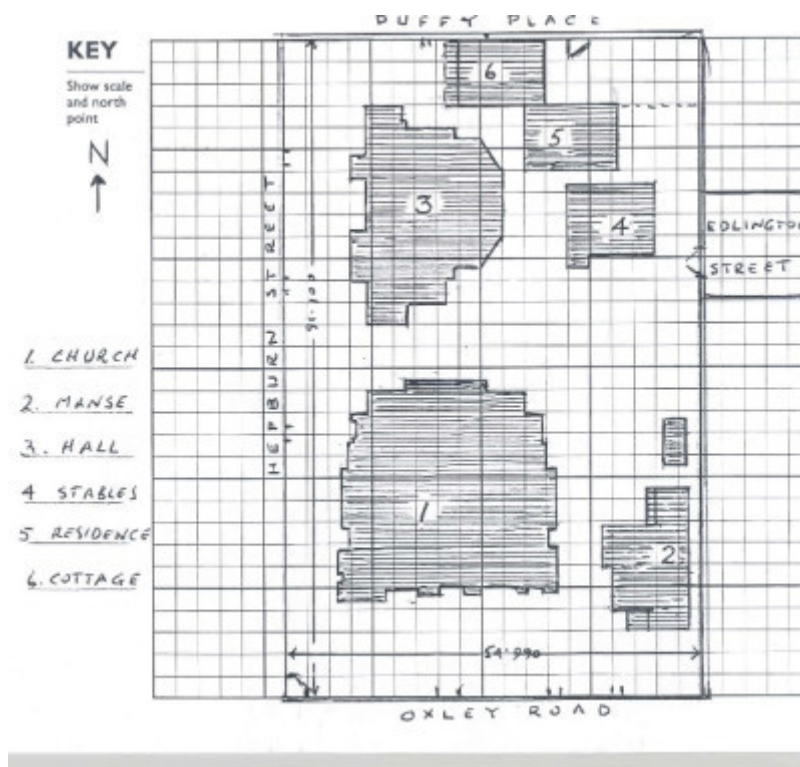

Uniting Church Plan of Buildings

## Location

81 OXLEY ROAD AND 3 HEPBURN STREET HAWTHORN, BOROONDARA CITY

## Municipality

BOROONDARA CITY

## Level of significance

Registered

## Victorian Heritage Register (VHR) Number

H2034

## Heritage Overlay Numbers

HO209

## VHR Registration

July 10, 2003

## Heritage Listing

Victorian Heritage Register

---

## Statement of Significance

Last updated on - July 10, 2003

What is significant?

Wesleyan Methodism was one of the flourishing denominations of the Hawthorn municipality in the second half of the nineteenth century. The local Methodist community was known as the "Hawthorn Circuit" and such was its influence that it was responsible for the establishment in 1881 of the Methodist Ladies' College (MLC), one of Melbourne's leading secondary schools for girls.

Between the 1840s and 1880s the Hawthorn Circuit occupied and subsequently outgrew a number of buildings until in 1886 a new, considerably larger, site was selected on the corner of Oxley Road and Hepburn Street.

The Trustees advertised in the *Argus*, inviting 'competitive designs for church, school and parsonage' on the new site. The successful design was submitted by talented young Melbourne architect Alfred Dunn, who designed a number of churches for the Wesleyans. Once begun, the entire complex took less than two years to construct and was completed in 1890. Dunn died at the age of 29, only a few years after the Auburn complex was finished.

The complex consists of a main church building, a church hall, parsonage, caretaker's cottage, former stables, and a former infants school. The perimeter brick wall may have replaced an earlier timber picket fence. However, it is the church itself which provided the symbol of the Hawthorn's Circuit's affluence, hailed as one of the finest Wesleyan Methodist churches in Victoria. Constructed on a hill, it became a prominent local landmark.

The main church building is constructed in the Lombardic Romanesque style. The predominant theme is the use of banded, dichromatic brickwork of Hawthorn browns contrasted with deep reds. The dominant element of the church is its multi-levelled tower, which addresses the corner of Oxley Road and Hepburn Street.

The main body of the church is two storeys high with a slate roof and has prominent balconies and gables addressing the streets. The relatively plain interior, with some classical detailing of pilasters with Corinthian capitals, is largely intact. It is arranged as a rectangular auditorium with original pews on a raked floor overlooking the chancel and the visual centrepiece of the church, the 1889 organ designed by Fincham and Hobday.

The parsonage, hall and cottage are architecturally complementary to the church building, similarly employing banded dichromatic brickwork on basalt plinths with slate roofs. The hall is a substantial building with separate entrances for boys and girls, a central stage with radiating classrooms and sliding dividing doors.

In 1902 the Wesleyan Methodists became part of the Methodist Church in Australia, which in turn combined with the Congregationalists and Presbyterians in 1977 to become the Uniting Church in Australia. Since that date the church has been known as the Auburn Uniting Church.

How is it significant?

The Auburn Uniting Church Complex is historically and architecturally significant to the State of Victoria.

Why is it significant?

The Auburn Uniting Church Complex is historically significant as the major nineteenth century Wesleyan complex in Victoria. It is unusual as an example of a complete, intact and little altered set of church buildings built simultaneously to one design. It is in contrast to other historical ecclesiastical complexes that have evolved over a longer period of time. The complex is historically significant for its early associations with Wesleyan Methodism, an important religious congregation in colonial Victoria, and with the influential Hawthorn Methodist circuit. With one of the largest church memberships, this circuit had the finest set of properties in Victoria and was responsible for the foundation of Methodist Ladies' College, a leading educational establishment for girls.

The Auburn Uniting Church Complex is architecturally significant as the finest example of Lombardic Romanesque church design in Australia. The church was hailed contemporarily as one of the finest Wesleyan churches in Victoria, and has subsequently been described as a cathedral of Victorian Wesleyanism. The church building is architecturally significant as the major work by the young and brilliant architect Alfred Dunn.

## Permit Exemptions

### General Exemptions:

General exemptions apply to all places and objects included in the Victorian Heritage Register (VHR). General exemptions have been designed to allow everyday activities, maintenance and changes to your property, which don't harm its cultural heritage significance, to proceed without the need to obtain approvals under the Heritage Act 2017.

Places of worship: In some circumstances, you can alter a place of worship to accommodate religious practices without a permit, but you must [notify](#) the Executive Director of Heritage Victoria before you start the works or activities at least 20 business days before the works or activities are to commence.

Subdivision/consolidation: Permit exemptions exist for some subdivisions and consolidations. If the subdivision or consolidation is in accordance with a planning permit granted under Part 4 of the *Planning and Environment Act 1987* and the application for the planning permit was referred to the Executive Director of Heritage Victoria as a determining referral authority, a permit is not required.

Specific exemptions may also apply to your registered place or object. If applicable, these are listed below. Specific exemptions are tailored to the conservation and management needs of an individual registered place or object and set out works and activities that are exempt from the requirements of a permit. Specific exemptions prevail if they conflict with general exemptions.

Find out more about heritage permit exemptions [here](#).

### Specific Exemptions:

General Conditions: 1. All exempted alterations are to be planned and carried out in a manner which prevents damage to the fabric of the registered place or object. General Conditions: 2. Should it become apparent during further inspection or the carrying out of alterations that original or previously hidden or inaccessible details of the place or object are revealed which relate to the significance of the place or object, then the exemption covering such alteration shall cease and the Executive Director shall be notified as soon as possible. General Conditions: 3. If there is a conservation policy and plan approved by the Executive Director, all works shall be in accordance with it. General Conditions: 4. Nothing in this declaration prevents the Executive Director from amending or rescinding all or any of the permit exemptions. General Conditions: 5. Nothing in this declaration exempts owners or their agents from the responsibility to seek relevant planning or building permits from the responsible authority where applicable.

## Removal of 20th century kitchen addition to Sunday School building

### Exterior of all buildings

- \* Minor repairs and maintenance which replace like with like.
- \* Removal of extraneous items such as air conditioners, pipe work, ducting, wiring, antennae, aerials etc, and making good.

### Interiors of buildings except church building

- \* Painting of previously painted walls and ceilings provided that preparation or painting does not remove evidence of the original paint or other decorative scheme.
- \* Removal of paint from originally unpainted masonry.
- \* Refurbishment of toilet facilities including removal, installation or replacement of fixtures and piping
- \* Removal or replacement of kitchen benches, cupboards and fixtures including sinks, stoves, ovens refrigerators, dishwashers etc and associated plumbing and wiring

### Interior of Manse

- \* Installation, removal or replacement of curtain track, rods, blinds and other window dressings.
- \* Installation, removal or replacement of hooks, nails and other devices for the hanging of mirrors, paintings and other wall mounted artworks.
- \* Removal of paint from originally unpainted or oiled joinery, doors, architraves and skirtings.
- \* Painting of previously painted walls and ceiling provided that preparation or painting does not remove evidence of the original painting or other decorative scheme.
- \* Installation, removal or replacement of carpets and flexible floor coverings.
- \* Installation, removal or replacement of kitchen benches, cupboards and fixtures including sinks, stoves, ovens refrigerators, dishwashers etc and associated plumbing and wiring
- \* Refurbishment of existing bathrooms, toilets and or en suites including removal, installation or replacement of sanitary fixtures and associated piping, mirrors, wall and floor coverings.
- \* Installation, removal and replacement of electrical wiring provided that all new wiring is fully concealed.
- \* Installation, removal and replacement of bulk insulation in the roof space.
- \* Installation, removal and replacement of smoke detectors Installation, removal or replacement of garden furniture and clothes hoists

Construction dates	1888,
Architect/Designer	Dunn, Alfred,
Heritage Act Categories	Registered place, Registered object integral to a registered place,
Other Names	WESLEYAN METHODIST CHURCH MANSE,
Hermes Number	3354
Property Number	

---

## History

### from RNE Database Number: 102040

Wesleyan Methodism was one of the predominant religious denominations of the Hawthorn municipality in the second half of the nineteenth century. The Wesleyan Methodist Church on Oxley Road was to be the fourth Wesleyan Methodist church in Hawthorn. The local Methodist community was known as the "Hawthorn Circuit" and such was its influence that it was responsible for the establishment in 1881 of the Methodist Ladies' College, one of Melbourne's leading secondary schools for girls.

The first Methodist services in Hawthorn in the 1840s and 1850s were held in a variety of locations and buildings, including under a tree (on the corner of Riversdale Road and Auburn Road), a framed tent, a weatherboard building and private residences. The existing congregations in Hawthorn united in 1855 to erect a brick church in

Riversdale Road, which was later sold (and subsequently demolished) in order to provide a larger building. A larger church was built in Burwood Road in 1856 and by 1872 the church had also begun to outgrow this building. A new, considerably larger, site was selected on the corner of Oxley Road and Hepburn Street, with the sale of the Burwood Road building to be used to finance the new church complex.

With the selection of the site, planning for the new complex proceeded slowly. Finally, in October 1884 the Trustees of the Wesleyan Church, Hawthorn, advertised in *The Argus*, inviting 'competitive designs for church, school and parsonage' on the new site. The successful design was submitted by talented young Melbourne architect Alfred Dunn, who subsequently put the construction project to tender in April 1888, engaging the Brewer Brothers of Clifton Hill to undertake the construction. By March 1889 all buildings on site had been completed apart from the caretaker's cottage and fencing around the buildings. These were subsequently completed by early 1890. The entire Auburn Wesleyan Methodist Church complex had been completed within two years.

When completed, the complex consisted of a main church building, a hall/Sunday School, a manse/parsonage, caretaker's residence and stables. However, it was the church itself which provided the symbol of the Hawthorn's Circle's affluence, hailed as the finest Wesleyan Methodist Church in Victoria. Constructed on a hill, it became a prominent local landmark.

In 1902 the Wesleyan Methodists became part of the Methodist Church in Australia, which in turn combined with the Congregationalists and Presbyterians in 1977 to become the Uniting Church in Australia. Since that date the church has been known as the Auburn Uniting Church.

## ALFRED DUNN

Alfred Dunn commenced a promising career in architecture in his early twenties, rapidly gaining a reputation for imaginative designs, especially in his ecclesiastical work. One of his first major projects was the model Sunday School building attached to the Percy Oakden designed Brunswick Wesleyan Methodist Church in 1887, thus commencing a strong working relationship between Dunn and the Methodists. At the same time as designing the Wesleyan complex at Hawthorn he created a similar design for the Wesleyan congregation at Preston, although less elaborate and in a more Gothic mould. Being young and unestablished, Dunn achieved most of his appointments through entering design competitions and contests for building projects. It was through this process that he produced designs for the Wesleyan Methodist Church in Hawthorn; he was also co-winner for the design of the acclaimed interiors of the (former) Commercial Bank of Australia Banking Chambers in 1893, a collaboration between himself and Lloyd Tayler. Sadly, Dunn's promising career was cut short by his tragic death, at the early age of 29, in 1894.

VICTORIAN CHURCH SURVEY - STATEMENT OF SIGNIFICANCE: AUBURN UNITING CHURCH IS ONE OF THE FINEST CHURCHES ERECTED IN VICTORIA IN THE LATER NINETEENTH CENTURY, IS A LOCAL LANDMARK AND HAS ADDED ARCHITECTURAL AND HISTORIC IMPORTANCE AS A COMPLEX WHICH WAS ALL BUILT AT THE SAME TIME. PROBABLY NOT SINCE THE CONSTRUCTION OF WESLEY CHURCH AND ITS ASSOCIATED BUILDINGS IN CENTRAL MELBOURNE WAS A WESLEYAN CHURCH COMPLEX OF SUCH A SUBSTANTIAL NATURE ERECTED ALL AT THE ONE TIME; SIGNIFICANTLY BOTH WERE FUNDED WITH THE PROCEEDS OF THE SALE OF THE PREVIOUS CHURCH AND SITE. IN THE CASE OF WESLEY CHURCH, THE FUNDS IN HAND PAID FOR THE ENTIRE PROJECT, AS WELL AS FOR CONTRIBUTIONS TO BUILD SEVERAL OTHER CHURCHES. AT AUBURN THERE WAS A SUBSTANTIAL DEBT AT THE COMPLETION OF THE BUILDING AND THE SPECTATOR HISTORIES OF CIRCA 1897 RECORD THAT HAWTHORN HAD THE MOST SUBSTANTIAL BUILDINGS OF ANY SUBURBAN CHURCH IN MELBOURNE AND ALSO THE LARGEST DEBT. DUE TO THE LATER DECLINE OF THE CONGREGATION THIS CENTURY, THE COMPLEX AS A WHOLE IS REMARKABLY INTACT AND THUS A MONUMENT TO THE SOCIAL AFFLUENCE AND OPTIMISM OF THE LATER 1880'S. THE MANSE IS A SUBSTANTIAL RESIDENCE AND IMPORTANT AS A PRINCIPAL MEMBER OF THE GROUP. THE ORIGINAL DOUBLE STOREY VERANDAH WAS REMOVED SOME TIME AGO.

## Plaque Citation

This church complex was built for the Wesleyan Methodists between 1888 and 1890. Designed by architect Alfred Dunn, the church is in the Lombardic Romanesque style and is one of the finest Wesleyan churches in Victoria.

#### Auburn Uniting Church Complex

is registered by the Heritage Council of Victoria

This church complex was built for the Wesleyan Methodists between 1888 and 1890. Designed by architect Alfred Dunn, the church is in the Lombardic Romanesque style and is one of the finest Wesleyan churches in Victoria.

Victorian Heritage Register Number H2034

### Extent of Registration

1. All the buildings marked B1 Church, B2 Parsonage, B3 Sunday School, B4 former stables, B5 former Infants School, B6 Caretaker's Cottage, B7 wall, as shown on Plan No. H2034 held by the Executive Director.
2. All the land marked L1 on Plan No H2034 held by the Executive Director, being the land described in Certificate of Title Volume 2104 Folio 420679.
3. All the objects, being the pews.

---

*This place/object may be included in the Victorian Heritage Register pursuant to the Heritage Act 2017. Check the Victorian Heritage Database, selecting 'Heritage Victoria' as the place source.*

*For further details about Heritage Overlay places, contact the relevant local council or go to Planning Schemes Online <http://planningschemes.dpcd.vic.gov.au/>*