

OLD MEN'S SHELTER



OLD MEN'S SHELTER
SOHE 2008



h00945 1 old men's shelter
powlett reserve cnr powlett
and albert east melbourne
front view



old men's shelter albert street
east melbourne rear view



h00945 old men's shelter
albert street east melbourne
front view

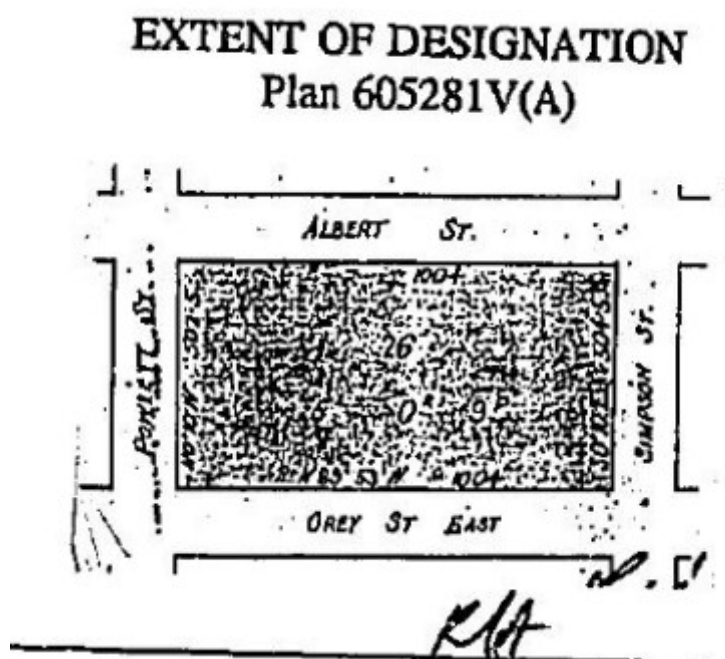

h00945 plan h0945

Location

POWLETT RESERVE, 61-67 ALBERT STREET AND 150-152 POWLETT STREET EAST MELBOURNE, MELBOURNE CITY

Municipality

MELBOURNE CITY

Level of significance

Registered

Victorian Heritage Register (VHR) Number

H0945

Heritage Overlay Numbers

HO128

VHR Registration

December 16, 1992

Heritage Listing

Victorian Heritage Register

Statement of Significance

Last updated on - February 9, 2000

Constructed in 1938, the Old Men's Shelter at Powlett Reserve is one of the earliest surviving examples of an old men's shelter and, while it illustrates the plight of elderly men residing in inner city boarding houses, it also represents community moves toward self-help after the 1930s depression. It marks the beginning of a movement which placed value on allowing the elderly to support each other and which eventually led to the formation of senior citizens clubs. It is a notable example of the decorative use of brickwork in the 1930s.

Permit Exemptions

General Exemptions:

General exemptions apply to all places and objects included in the Victorian Heritage Register (VHR). General exemptions have been designed to allow everyday activities, maintenance and changes to your property, which don't harm its cultural heritage significance, to proceed without the need to obtain approvals under the Heritage Act 2017.

Places of worship: In some circumstances, you can alter a place of worship to accommodate religious practices without a permit, but you must [notify](#) the Executive Director of Heritage Victoria before you start the works or activities at least 20 business days before the works or activities are to commence.

Subdivision/consolidation: Permit exemptions exist for some subdivisions and consolidations. If the subdivision or consolidation is in accordance with a planning permit granted under Part 4 of the *Planning and Environment Act 1987* and the application for the planning permit was referred to the Executive Director of Heritage Victoria as a determining referral authority, a permit is not required.

Specific exemptions may also apply to your registered place or object. If applicable, these are listed below. Specific exemptions are tailored to the conservation and management needs of an individual registered place or object and set out works and activities that are exempt from the requirements of a permit. Specific exemptions prevail if they conflict with general exemptions.

Find out more about heritage permit exemptions [here](#).

Construction dates	1938,
Heritage Act Categories	Registered place,
Hermes Number	354
Property Number	

Extent of Registration

AMENDMENT OF REGISTER OF HISTORIC BUILDINGS

Old Men's Shelter, Powlett Reserve, corner Albert and Powlett Streets, East Melbourne.

(Tot the extent of:

1. All the building known as the Old Man's Shelter, Powlett Reserve, East Melbourne.
2. All the land surrounding the above building to a distance of 8 metres from the base of the building to the south and to the east; to Albert Street to the north; and to Powlett Street to the west, being part of the land contained in Certificate of Title Volume 4505 Folio 900983, shown on Plan 605281V(A) endorsed by the Chairperson, Historic Buildings Council, and held by the Director, Historic Buildings Council.)

[*Victoria Government Gazette* G 49 16 December 1992 p.3818]

This place/object may be included in the Victorian Heritage Register pursuant to the Heritage Act 2017. Check the Victorian Heritage Database, selecting 'Heritage Victoria' as the place source.

For further details about Heritage Overlay places, contact the relevant local council or go to Planning Schemes Online <http://planningschemes.dpcd.vic.gov.au/>