

EUROA COURT HOUSE



EUROA COURT HOUSE
SOHE 2008



h00960 1 euroa court house
binney street euroa street
view she project 2004



euroa courthouse detail of
entrance



euroa courthouse rear view

Plan No.602318V

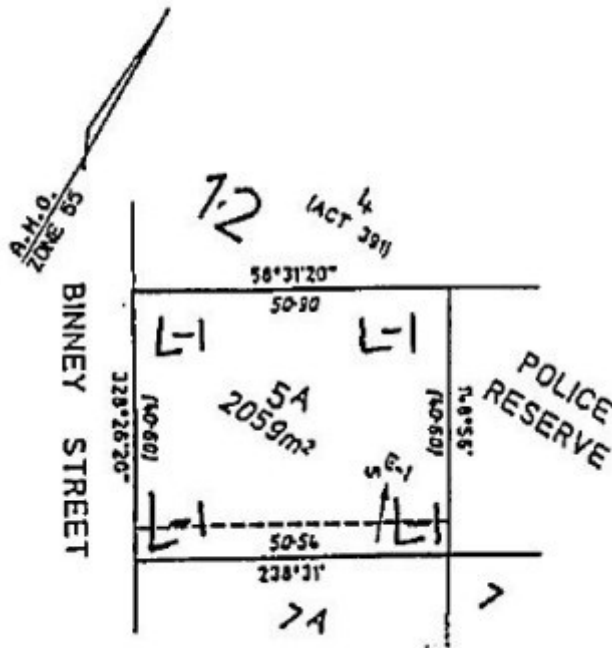

h00960 plan h0960

Location

99 BINNEY STREET EUROA, STRATHBOGIE SHIRE

Municipality

STRATHBOGIE SHIRE

Level of significance

Registered

Victorian Heritage Register (VHR) Number

H0960

Heritage Overlay Numbers

HO3

VHR Registration

August 20, 1982

Amendment to Registration

April 13, 1995

Heritage Listing

Victorian Heritage Register

Statement of Significance

Last updated on - February 29, 2000

The former Euroa Court House, constructed in 1892, was designed by JT Kelleher and shows the clear influence of AJ Macdonald, both of the Public Works Department. The building is an outstanding and essentially intact example of a small number of buildings designed at a time when the Public Works Department was experimenting with new styles while exploring the idea of a uniquely Australian architecture. The former Euroa Court House is one of a group of buildings responding to the American Romanesque of the late nineteenth century. Other related buildings from this period are Euroa and South Yarra Post Offices; Flemington and Omeo Court Houses.

The former Euroa Court House is essentially intact and retains a substantial part of its purpose built furniture including witness box, prisoner's dock, clerk of court's bench and judicial bench.

Permit Exemptions

General Exemptions:

General exemptions apply to all places and objects included in the Victorian Heritage Register (VHR). General exemptions have been designed to allow everyday activities, maintenance and changes to your property, which don't harm its cultural heritage significance, to proceed without the need to obtain approvals under the Heritage Act 2017.

Places of worship: In some circumstances, you can alter a place of worship to accommodate religious practices without a permit, but you must **notify** the Executive Director of Heritage Victoria before you start the works or activities at least 20 business days before the works or activities are to commence.

Subdivision/consolidation: Permit exemptions exist for some subdivisions and consolidations. If the subdivision or consolidation is in accordance with a planning permit granted under Part 4 of the *Planning and Environment Act 1987* and the application for the planning permit was referred to the Executive Director of Heritage Victoria as a determining referral authority, a permit is not required.

Specific exemptions may also apply to your registered place or object. If applicable, these are listed below. Specific exemptions are tailored to the conservation and management needs of an individual registered place or object and set out works and activities that are exempt from the requirements of a permit. Specific exemptions prevail if they conflict with general exemptions.

Find out more about heritage permit exemptions [here](#).

| | |
|-------------------------|------------------------|
| Construction dates | 1892, |
| Architect/Designer | Kelleher, John Thomas, |
| Heritage Act Categories | Registered place, |
| Other Names | EUROA COURTHOUSE, |
| Hermes Number | 440 |
| Property Number | |

Extent of Registration

AMENDMENT OF REGISTER OF HISTORIC BUILDINGS

Historic Building No. 960:

Former Court House, Binney Street, Euroa.

(To the extent of:

1. All of the building known as the former Court House, Euroa including the prisoner's dock, witness box, clerk of court's bench and judicial bench; and
2. All of the land marked L-1 on Plan No. 602318V endorsed by the Chairperson, Historic Buildings Council and held by the Director, Historic Buildings Council being all of the land described in Plan of Crown Allotment CP110977.)

[Victoria Government Gazette No. G14 13 April 1995 p.899]

This place/object may be included in the Victorian Heritage Register pursuant to the Heritage Act 2017. Check the Victorian Heritage Database, selecting 'Heritage Victoria' as the place source.

For further details about Heritage Overlay places, contact the relevant local council or go to Planning Schemes Online <http://planningschemes.dpcd.vic.gov.au/>