

OSBORNE HOUSE



OSBORNE HOUSE SOHE
2008



osborne house nicholson
street fitzroy front view
jun1979



1 osborne house nicholson
street fitzroy entrance view
jan1978



osborne house nicholson
street fitzroy gates jan1979



osborne house nicholson
street fitzroy verandah
jan1979

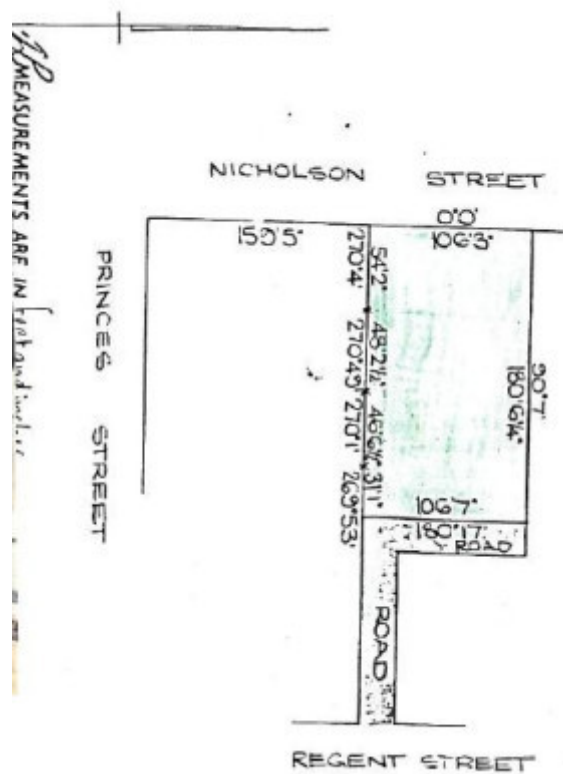

H1607 H1607 plan

Location

40 NICHOLSON STREET FITZROY, YARRA CITY

Municipality

YARRA CITY

Level of significance

Registered

Victorian Heritage Register (VHR) Number

H1607

Heritage Overlay Numbers

HO182

VHR Registration

November 14, 1979

Amendment to Registration

May 23, 1998

Heritage Listing

Victorian Heritage Register

Statement of Significance

Last updated on - February 1, 2010

WHEA AREA OF GREATER SIGNIFICANCE

Osborne House was built initially in 1850-51 as a two-storey Regency style house for the wealthy pioneer pastoralist John MacPherson (1798-1875) and his wife Helen, and was then called Helena House. It was designed by the architect Charles Laing and constructed by the builder William Pelling. MacPherson's son John Alexander MacPherson (1833-94) lived at the house during his term as Premier of Victoria in 1869-70. The house was sold in 1877 to Robert Smith, a timber merchant, who added a single storey verandah to the front c1880. In 1887 it was sold to George Nipper (1838-1913), who at the same time purchased the adjoining buildings at numbers 38, 42 and 44 Nicholson Street. Nipper was a local businessman and entrepreneur, who was also responsible for the building of the Windsor Hotel. In 1887-8 Nipper made substantial additions to the buildings at 38-44 Nicholson Street, probably to the designs of Charles Webb, resulting in a boarding house of eighty-eight rooms. This was probably motivated by the Great Centennial Exhibition planned to be held in 1888 in the Exhibition Building opposite. This was Queen Victoria's Jubilee Year, and he named the main part of his boarding house Osborne House, after the Queen's family home, and the southern wing Salisbury House, after her then Prime Minister. Three storey wings were added on each side of the original house, with an encircling two-storey cast iron verandah, and further wings at the rear. The boarding house had sixty bedrooms, two large drawing rooms, and billiard and smoking rooms. Since then Osborne House has continued to operate as a boarding house, most recently as community housing. The footprint of the house has remained largely unchanged since Nipper's time, but internal changes were made in 1984 and in 1995 to upgrade the facilities.

Osborne House is a brick building with the original freestanding symmetrical rendered Regency style two-storey house set back from Nicholson Street now flanked by the 1887-8 extensions: to the south the three storey Salisbury House with a long wing at the rear; the three storey north wing with two shops on the ground floor; and two parallel two-storey wings at the rear of the 1850 house. A two storey cast iron verandah wraps around the entry court formed by the addition of the north and south wings and across the front of Salisbury House. Some Regency features of the 1850 house survive, notably the Tuscan portico and solid slate steps, the front door and the windows, and internally the black and white inlaid marble and slate floor in the entry foyer, the moulded door frames, some folding shutters in one of the front rooms, the room layout with four rooms opening off the central hall on each level, and the original staircase. The 1880s wings internally have multiple small rooms, which have been altered to suit modern needs, opening off undecorated narrow corridors. The roof was originally slate, but is now corrugated iron. Osborne House is part of the World Heritage Environs Area of the Royal Exhibition Building and Carlton Gardens.

Osborne House is of historical and architectural significance to the state of Victoria.

Osborne house is of historical significance as an outstanding example of a nineteenth century boarding house, whose significance is increased by its association with the Great Centennial Exhibition of 1888 and its proximity to the World Heritage listed Royal Exhibition Building and Carlton Gardens. It is significant as a demonstration of the way of life of wealthier Victorians in the mid-nineteenth century, and the social and economic changes which have taken place in the inner suburbs since that time. This part of Fitzroy was in 1850 a prestigious residential area, but the opening of the railways to the eastern suburbs in the 1880s meant that these now became the preferred residential areas, and many of the large Fitzroy houses were converted to boarding houses. It is of historical significance for its association with several eminent Victorians: the pioneer pastoralist John MacPherson; his son John Alexander MacPherson, a prominent parliamentarian and Premier of Victoria 1869-70; the famous French violinist and composer Horace Poussard, who leased the house in 1885-6; and the entrepreneur George Nipper, who built some of Melbourne's notable Boom period buildings.

Osborne House is of architectural significance for the Regency style house at the core of the building, the former Helena House, the oldest documented residential building surviving in Fitzroy and one of the oldest in Melbourne. With the 1880s additions it is significant as a fine and intact example of a large Boom period boarding house, and for its unusual form, with an impressive two storey cast iron verandah wrapped around the entrance forecourt. It is significant for its association with two of Melbourne's most important nineteenth century architects: Charles Laing and Charles Webb.

[This statement of significance was updated as part of the Data Upgrade Project 2010]

Permit Exemptions

General Exemptions:

General exemptions apply to all places and objects included in the Victorian Heritage Register (VHR). General exemptions have been designed to allow everyday activities, maintenance and changes to your property, which don't harm its cultural heritage significance, to proceed without the need to obtain approvals under the Heritage Act 2017.

Places of worship: In some circumstances, you can alter a place of worship to accommodate religious practices without a permit, but you must [notify](#) the Executive Director of Heritage Victoria before you start the works or activities at least 20 business days before the works or activities are to commence.

Subdivision/consolidation: Permit exemptions exist for some subdivisions and consolidations. If the subdivision or consolidation is in accordance with a planning permit granted under Part 4 of the *Planning and Environment Act 1987* and the application for the planning permit was referred to the Executive Director of Heritage Victoria as a determining referral authority, a permit is not required.

Specific exemptions may also apply to your registered place or object. If applicable, these are listed below. Specific exemptions are tailored to the conservation and management needs of an individual registered place or object and set out works and activities that are exempt from the requirements of a permit. Specific exemptions prevail if they conflict with general exemptions.

Find out more about heritage permit exemptions [here](#).

Construction dates	1850, 1888,
Architect/Designer	Laing, Charles, Webb, Charles,
Heritage Act Categories	Registered place,
Hermes Number	480
Property Number	

History

Associated People:

Plaque Citation

This 1887-8 boarding house was the result of additions by the architect Charles Webb to an 1850 Regency style house, to provide accommodation for the 1888 Centennial Exhibition, held at the Exhibition Building opposite.

Extent of Registration

Osborne House, 40 Nicholson Street, Fitzroy.

[*Victoria Government Gazette* No.G18 10 May 1989 p.1127]

This place/object may be included in the Victorian Heritage Register pursuant to the Heritage Act 2017. Check the Victorian Heritage Database, selecting 'Heritage Victoria' as the place source.

For further details about Heritage Overlay places, contact the relevant local council or go to Planning Schemes Online <http://planningschemes.dpcd.vic.gov.au/>