

## FORMER NORTH FITZROY POST OFFICE



FORMER NORTH FITZROY  
POST OFFICE SOHE 2008



1 former north fitzroy port  
office st georges road fitzroy  
front corner elevation



former north fitzroy port office  
st georges road fitzroy front  
elevation



former north fitzroy post office  
st georges road fitzroy side  
view

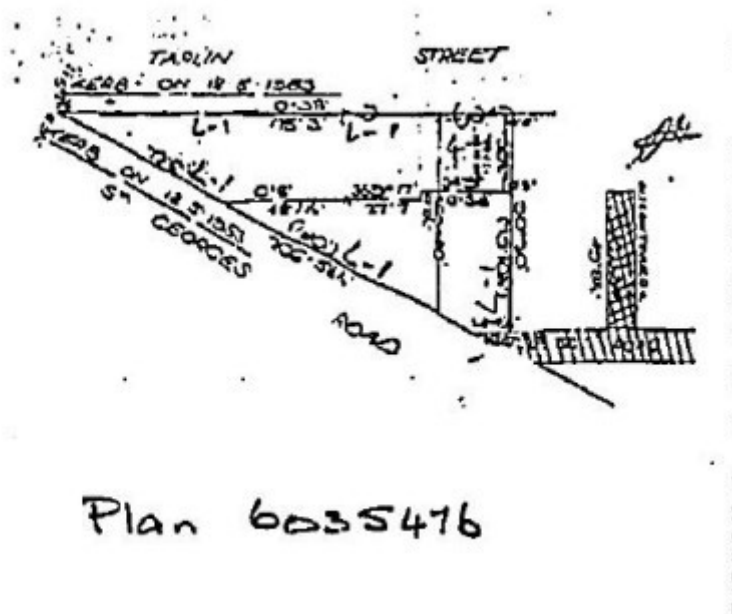

h00900 plan h0900

251 ST GEORGES ROAD FITZROY NORTH, YARRA CITY

## **Municipality**

YARRA CITY

## **Level of significance**

Registered

## **Victorian Heritage Register (VHR) Number**

H0900

## **Heritage Overlay Numbers**

HO220

## **VHR Registration**

December 11, 1992

## **Heritage Listing**

Victorian Heritage Register

---

## **Statement of Significance**

Last updated on - March 17, 2025

### **What is significant?**

The Former North Fitzroy Post Office was built for real estate agent Thomas Rogers c 1886-1887 and served as a land office until 1890. From 1890 until 1907 it was owned by the Standard Building Society and used for a variety of purposes. In 1908 it was sold to the Post Master General and modified to become a post office. The two storey brick structure is situated on an acute angled site and has rendered, highly decorated facades. The apex of the building features a hexagonal tower, the dome of which has unfortunately been removed. The first floor has Corinthian half columns and arched windows. The entablature and balustraded parapet incorporate pediment motifs. External features include lion figures, floral scrolls and rosettes. The interior, although substantially altered in 1908, retains a number of decorative features.

### **How is it significant?**

The Former North Fitzroy Post Office is of architectural and historical significance to the State of Victoria.

### **Why is it significant?**

The Former North Fitzroy Post Office is of architectural significance for its fine boom Classical style treatment of a corner site and for its demonstration of boom-period building techniques and technologies. The building is located on a prominent corner location, important for its original purpose as a land sale office, and the composition with corner tower and two identical flanking facades is a typical design solution for such allotments. Few examples of this composition survive today. The Former Post Office is significant for its largely intact exterior, which demonstrates the use of mass-produced decorative features that could be purchased 'off the shelf' and applied to a building in a variety of combinations. Similar features are also in evidence in the interior, although affected by the 1908 alterations. Perforated or hollow cornices in the ground floor public areas allow air flow to the outside, and are an important example of late 19th century building technology.

The Former North Fitzroy Post Office is of historical significance as evidence of the land speculation and building boom of the 1880s. The shape and location of the building were almost certainly intended as a form of advertisement for Rogers' land sale business, the prominent structure overlooking the streets and lanes where land was for sale. North Fitzroy underwent rapid expansion during the 1880s, with a population increase of

almost 10,000; the building represents a substantial reminder of this period of growth and consolidation of Melbourne and Victoria.

The Former North Fitzroy Post Office is of historical significance for what it reveals about the development of the postal service in the early 20th century. The building featured a large residence for the postmaster/mistress, an interesting trace of the organisational and employment forms of the early 20th century. The development of new technologies in the early years of the 20th century was reflected in the incorporation of a telephone bureau in the 1908 alterations to the building.

## Permit Exemptions

### General Exemptions:

General exemptions apply to all places and objects included in the Victorian Heritage Register (VHR). General exemptions have been designed to allow everyday activities, maintenance and changes to your property, which don't harm its cultural heritage significance, to proceed without the need to obtain approvals under the Heritage Act 2017.

**Places of worship:** In some circumstances, you can alter a place of worship to accommodate religious practices without a permit, but you must **notify** the Executive Director of Heritage Victoria before you start the works or activities at least 20 business days before the works or activities are to commence.

**Subdivision/consolidation:** Permit exemptions exist for some subdivisions and consolidations. If the subdivision or consolidation is in accordance with a planning permit granted under Part 4 of the *Planning and Environment Act 1987* and the application for the planning permit was referred to the Executive Director of Heritage Victoria as a determining referral authority, a permit is not required.

Specific exemptions may also apply to your registered place or object. If applicable, these are listed below. Specific exemptions are tailored to the conservation and management needs of an individual registered place or object and set out works and activities that are exempt from the requirements of a permit. Specific exemptions prevail if they conflict with general exemptions.

Find out more about heritage permit exemptions [here](#).

|                         |                                   |
|-------------------------|-----------------------------------|
| Construction dates      | 1888,                             |
| Heritage Act Categories | Registered place,                 |
| Other Names             | Former Fitzroy North Post Office, |
| Hermes Number           | 488                               |
| Property Number         |                                   |

---

## Extent of Registration

### AMENDMENT OF REGISTER OF HISTORIC BUILDINGS

Historic Building No. 900.

North Fitzroy Post Office

251 St Georges Road, North Fitzroy.

To the extent of:

1. the building known as the North Fitzroy Post Office, 251 St Georges Road, North Fitzroy, and
2. the land marked L-1 on Plan 6035476, endorsed by the Chairperson, Historic Buildings Council, and held by

the Director, Historic Buildings Council, being all the land described in Certificate of Title Vol. 8059 Folio 053.  
[Victoria Government Gazette No. G48 11 December 1991 p.3455]

*This place/object may be included in the Victorian Heritage Register pursuant to the Heritage Act 2017. Check the Victorian Heritage Database, selecting 'Heritage Victoria' as the place source.*

*For further details about Heritage Overlay places, contact the relevant local council or go to Planning Schemes Online <http://planningschemes.dpcd.vic.gov.au/>*