

ST MONICAS CATHOLIC CHURCH



ST MONICAS CATHOLIC CHURCH SOHE 2008



1 st monicas catholic church
mount alexander road
moonee ponds front elevation
may1996

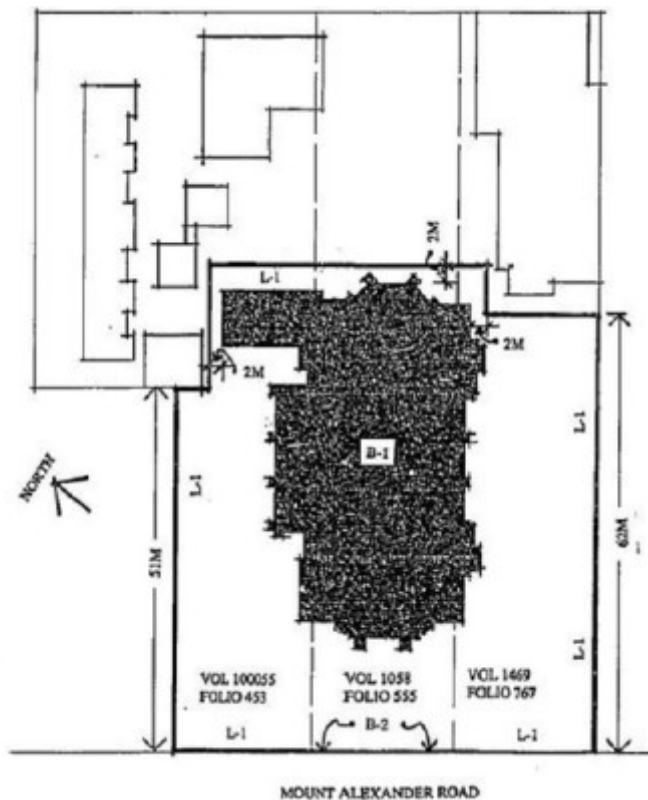

h01217 plan h1217

Location

818 MOUNT ALEXANDER ROAD MOONEE PONDS, MOONEE VALLEY CITY

Municipality

MOONEE VALLEY CITY

Level of significance

Registered

Victorian Heritage Register (VHR) Number

H1217

Heritage Overlay Numbers

HO86

VHR Registration

October 24, 1996

Heritage Listing

Victorian Heritage Register

Statement of Significance

Last updated on - May 11, 1999

St Monica's Catholic Church Moonee Ponds was designed by the architectural firm Payne & Dale and constructed by Simmie and Co in 1934 to seat a congregation of 1,200. It was built to replace a smaller church built on the same site in 1884 to a design by Reid & Barnes and demolished in 1934. The construction of the present church, described at the time a 'a modern version of the Spanish Gothic style, reminiscent of the Catalan School', was carried out in stages and initially incorporated the sanctuary of the earlier church.

The sanctuary was replaced in 1941 also to the design of Payne & Dale. In 1971 alterations were undertaken to reflect changes in the liturgy following Vatican II and included the removal of the altar rail and the extension of the sanctuary into the nave. The alterations were also supervised by TG Payne. The stained glass windows in the main body of the church are by Hardman of Birmingham and date from the 1940s and 1950s.

St Monica's Catholic Church Moonee Ponds is of architectural, social and historical importance to the State of Victoria.

St Monica's is of architectural importance for its high degree of creative accomplishment including its elaborate tracery and its soaring hall-church interior lit by spectacular stained glass. It is an important work of architects Payne & Dale who designed a number of buildings for the Catholic Church in the 20th century. It is also important for its high degree of intactness

St Monica's is historically and socially important as an ambitious example of the Catholic Church's policy to maintain building programmes during the Great Depression. It is one of the largest suburban churches of the period and is important as the most impressive Catholic Church constructed in the western suburbs in the twentieth century.

Permit Exemptions

General Exemptions:

General exemptions apply to all places and objects included in the Victorian Heritage Register (VHR). General exemptions have been designed to allow everyday activities, maintenance and changes to your property, which don't harm its cultural heritage significance, to proceed without the need to obtain approvals under the Heritage Act 2017.

Places of worship: In some circumstances, you can alter a place of worship to accommodate religious practices without a permit, but you must **notify** the Executive Director of Heritage Victoria before you start the works or activities at least 20 business days before the works or activities are to commence.

Subdivision/consolidation: Permit exemptions exist for some subdivisions and consolidations. If the subdivision or consolidation is in accordance with a planning permit granted under Part 4 of the *Planning and Environment Act 1987* and the application for the planning permit was referred to the Executive Director of Heritage Victoria as a determining referral authority, a permit is not required.

Specific exemptions may also apply to your registered place or object. If applicable, these are listed below. Specific exemptions are tailored to the conservation and management needs of an individual registered place or object and set out works and activities that are exempt from the requirements of a permit. Specific exemptions prevail if they conflict with general exemptions.

Find out more about heritage permit exemptions [here](#).

Specific Exemptions:

Nil

Construction dates	1934,
Architect/Designer	Payne & Dale,
Heritage Act Categories	Registered place,
Hermes Number	4916
Property Number	

Extent of Registration

NOTICE OF REGISTRATION

As Executive Director for the purpose of the Heritage Act, I give notice under section 46 that the Victorian Heritage Register is amended by including the Heritage Register Number 1217 in the category described as a Heritage Place:

St Monica's Catholic Church, 818 Mt Alexander Road, Moonee Ponds, Moonee Valley City Council.

EXTENT:

1. All of the building known as St Monica's Catholic Church, Moonee Ponds marked B-1 and the front fence marked B-2 on Diagram 607305 held by the Executive Director of the Heritage Council.
2. All of the land marked L-1 on Diagram 607305 held by the Executive Director of the Heritage Council, being part of the land described in Certificate of Title Volume 10055, Folio 453, Volume 1058, Folio 555 and Volume

1469, Folio 767.

Dated 3 October 1996

RAY TONKIN

Executive Director

[Victoria Government Gazette No. G42 24 October 1996 pp.2775-2776]

This place/object may be included in the Victorian Heritage Register pursuant to the Heritage Act 2017. Check the Victorian Heritage Database, selecting 'Heritage Victoria' as the place source.

For further details about Heritage Overlay places, contact the relevant local council or go to Planning Schemes Online <http://planningschemes.dpcd.vic.gov.au/>