

VAUGHAN CHINESE CEMETERY



VAUGHAN CHINESE
CEMETERY SOHE 2008



1 vaghan chinese cemetery
castlemaine road vaghan
detail

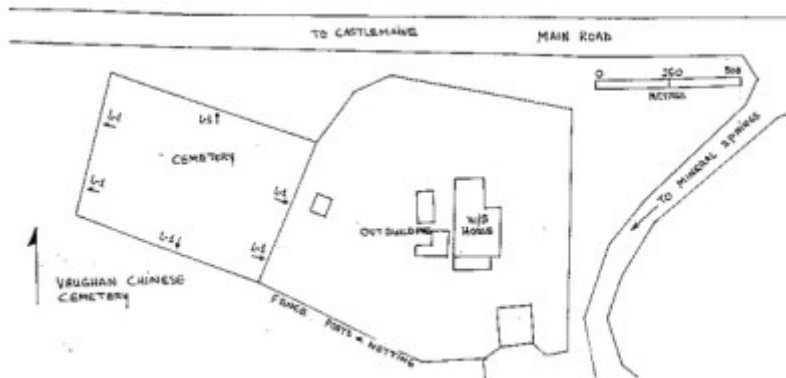

vaghan chinese cemetery castlemaine road vaghan plan

Location

GREVILLE STREET VAUGHAN, MOUNT ALEXANDER SHIRE

Municipality

MOUNT ALEXANDER SHIRE

Level of significance

Registered

Victorian Heritage Register (VHR) Number

H1408

Heritage Overlay Numbers

HO965

VHR Registration

February 12, 1998

Heritage Listing

Victorian Heritage Register

Statement of Significance

Last updated on - May 19, 1999

Primary historical records on Vaughan Chinese Cemetery are scant. Its origins lie in the great Mount Alexander alluvial goldrush of 1852-54. The cemetery is situated on a small rocky hill overlooking the junction of the Loddon River and Fryers Creek, one of the richest spots on the goldfield. Gold seekers chose a convenient patch of ground where gold was unlikely to be found. The cemetery remained in use until 1857. With the arrival of large numbers of Chinese gold seekers from 1854, burials in the cemetery appear to have had been predominantly from this population. This was a reflection of the field's changing nature: European miners preferring to follow the rush to new goldfields, while the Chinese were willing to put long hours into winning gold from worked-out and badly disturbed ground.

The Vaughan Chinese Cemetery is of historical, archaeological and scientific importance to the State of Victoria.

The Vaughan Chinese Cemetery is historically important due to its association with a key event in Victoria's history and a defining moment in the development of Australia's character and culture. The cemetery is also significant as an artefact that is strongly associated with Chinese miners, a connection still apparent in 1929 when the cemetery was restored using money raised within the Chinese communities at Castlemaine and Bendigo.

The Vaughan Chinese Cemetery is historically and scientifically important as a very rare artefact of Victoria's greatest gold rush. A comprehensive archaeological survey of the Castlemaine district undertaken in 1989 concluded that 'because of the ephemeral nature of structures and technology (predominantly, timber and human sweat) employed in the early gold-rush days there is little physical evidence of the intensity of activity and cathartic social experience sustained by the study area during the rush years. The significance of this site is also derived from its setting: the cemetery overlooking the gold-bearing flat and the once-large town that grew around the diggings.

Permit Exemptions

General Exemptions:

General exemptions apply to all places and objects included in the Victorian Heritage Register (VHR). General exemptions have been designed to allow everyday activities, maintenance and changes to your property, which don't harm its cultural heritage significance, to proceed without the need to obtain approvals under the Heritage Act 2017.

Places of worship: In some circumstances, you can alter a place of worship to accommodate religious practices without a permit, but you must [notify](#) the Executive Director of Heritage Victoria before you start the works or activities at least 20 business days before the works or activities are to commence.

Subdivision/consolidation: Permit exemptions exist for some subdivisions and consolidations. If the subdivision or consolidation is in accordance with a planning permit granted under Part 4 of the *Planning and Environment Act 1987* and the application for the planning permit was referred to the Executive Director of Heritage Victoria as a determining referral authority, a permit is not required.

Specific exemptions may also apply to your registered place or object. If applicable, these are listed below. Specific exemptions are tailored to the conservation and management needs of an individual registered place or object and set out works and activities that are exempt from the requirements of a permit. Specific exemptions prevail if they conflict with general exemptions.

Find out more about heritage permit exemptions [here](#).

Specific Exemptions:

EXEMPTIONS FROM PERMITS:

(Classes of works or activities which may be undertaken without a permit under Part 4 of the Heritage Act 1995)

General Conditions:

All permit exempt alterations are to be planned and carried out in a manner which prevents damage to the fabric of the registered place or object. Should it become apparent during further inspection or the carrying out of alterations that original or previously hidden or inaccessible details of the place or object are revealed which relate to the significance of the place or object, then the exemption covering such alteration shall cease and the Executive Director shall be notified as soon as possible.

If there is a conservation policy and plan approved by the Executive Director, all works shall be in accordance with it.

Nothing in this declaration prevents the Executive Director from amending or rescinding all or any of the permit exemptions.

Nothing in this declaration exempts owners or their agents from the responsibility to seek relevant planning or building permits from the responsible authority where applicable.

Layout

Repairs, conservation and maintenance to hard landscape elements, buildings and structures, ornaments, roads and paths, fences and gates, drainage and irrigation systems

Landscape

The process of gardening and maintenance to care for the cemetery landscape, planting themes and removal of dead plants

Management of plants in accordance with Australian Standard, Pruning of amenity trees AS 4373

Removal of vegetation to maintain fire safety and to protect registered buildings and structures

Removal of plants listed as State Prohibited and Regionally Controlled Weeds in the Catchment and Land Protection Act 1994

Construction dates 1852,
Heritage Act Categories Registered place,
Hermes Number 5381
Property Number

Extent of Registration

NOTICE OF REGISTRATION

As Executive Director for the purpose of the Heritage Act, I give notice under Section 46 that the Victorian Heritage Register is amended in that the Heritage Register Number that the Heritage Register Number that the Heritage Register Number that the Heritage Register Number 1408 is now described in the category as a Heritage Place:

Vaughan Chinese Cemetery, Castlemaine Road, Vaughan, Mt Alexander Shire Council.

EXTENT

1. All of the land marked L-1 including above-ground structures (gravestones and headstones), trees and all archaeological deposits and artefacts on Diagram 608091A held by the Executive Director being all the Crown Land included in the cemetery reserve, RS3188, in the Vaughan and Glenluce Mineral Springs Reserve, P120386, Allotment 11F of 3A, Parish of Fryers, County of Talbot.

Dated 5 February 1998

RAY TONKIN
Executive Director

[Victoria Government Gazette No. G6 12 February 1998 pp.348-349]

This place/object may be included in the Victorian Heritage Register pursuant to the Heritage Act 2017. Check the Victorian Heritage Database, selecting 'Heritage Victoria' as the place source.

For further details about Heritage Overlay places, contact the relevant local council or go to Planning Schemes Online <http://planningschemes.dpcd.vic.gov.au/>