

GORDON RAILWAY STATION



GORDON RAILWAY STATION SOHE 2008



GORDON RAILWAY STATION SOHE 2008



GORDON RAILWAY STATION SOHE 2008



GORDON RAILWAY STATION SOHE 2008



GORDON RAILWAY STATION SOHE 2008



1 gordon railway station
gowrie street gordon platform
view nov1986



gordon railway station gowrie
street gordon front view
nov1986



gordon railway station gowrie
street gordon side view
nov1986



Gordon Railway Station 2004

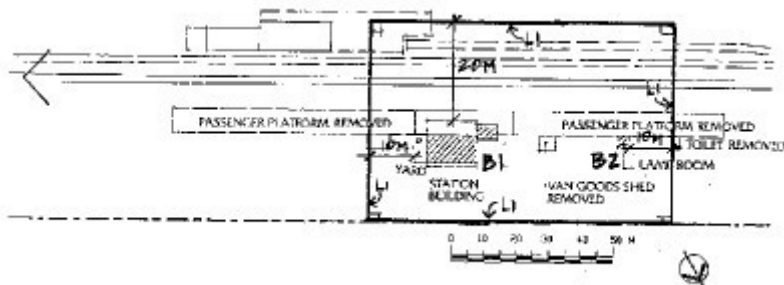

gordon railway station plan

Location

GORDON-EGERTON ROAD GORDON, MOORABOOL SHIRE

Municipality

MOORABOOL SHIRE

Level of significance

Registered

Victorian Heritage Register (VHR) Number

H1564

Heritage Overlay Numbers

HO35

VHR Registration

August 20, 1982

Amendment to Registration

July 20, 2000

Heritage Listing

Victorian Heritage Register

Statement of Significance

Last updated on - May 2, 2000

What is significant?

The Gordon Railway Station was constructed in 1879 by TW Cowley, on the Melbourne-Ballarat line, for the Victorian Railways. It comprises a distinctive, curved roof station building. The building formerly included a residence but the interior has been altered to provide a central booking lobby and an enlarged stationmaster's office. The station is of timber construction with posted verandahs along the platform and roadside elevations. Other structures include a corrugated iron clad lamp room and toilet. The goods shed and its associated platforms and the up-side and down-side sections of the passenger platform have been removed. The station was closed in the 1980s and currently serves as an office for the Railway Historical Society.

How is it significant?

Gordon Railway Station is historically and architecturally significant to the State of Victoria.

Why is it significant?

The Gordon Railway Station is historically significant for its associations with the Geelong-Ballarat Line, one of Victoria's first railway lines. The station is rare and intact example of a station building during the 'light lines' era, along one of the 'main trunk' lines.

The station is architecturally significant as a rare and intact example of a station building in the 'light lines' style along one of the 'main trunk' lines. Gordon Railway Station post dates the first generation of 'Bealiba' style buildings, and predates the second generation of 1881-1887. Designed as an experimental prototype, it was an economic solution to the previously costly construction of railway station buildings, and remains today as the only example of its type.

Permit Exemptions

General Exemptions:

General exemptions apply to all places and objects included in the Victorian Heritage Register (VHR). General exemptions have been designed to allow everyday activities, maintenance and changes to your property, which don't harm its cultural heritage significance, to proceed without the need to obtain approvals under the Heritage Act 2017.

Places of worship: In some circumstances, you can alter a place of worship to accommodate religious practices without a permit, but you must [notify](#) the Executive Director of Heritage Victoria before you start the works or activities at least 20 business days before the works or activities are to commence.

Subdivision/consolidation: Permit exemptions exist for some subdivisions and consolidations. If the subdivision or consolidation is in accordance with a planning permit granted under Part 4 of the *Planning and Environment Act 1987* and the application for the planning permit was referred to the Executive Director of Heritage Victoria as a determining referral authority, a permit is not required.

Specific exemptions may also apply to your registered place or object. If applicable, these are listed below. Specific exemptions are tailored to the conservation and management needs of an individual registered place or object and set out works and activities that are exempt from the requirements of a permit. Specific exemptions prevail if they conflict with general exemptions.

Find out more about heritage permit exemptions [here](#).

Specific Exemptions:

General Conditions

1. All alterations are to be planned and carried out in a manner that prevents damage to the fabric of the registered place or object.
2. Should it become apparent during further inspection or the carrying out of alterations that original or previously hidden or inaccessible details of the place or object are revealed which relate to the significance of the place or object, then the exemption covering such alteration shall cease and the Executive Director shall be notified as soon as possible.
3. If there is a conservation policy and plan approved by the Executive Director, all works shall be in accordance with it.
4. Nothing in this declaration prevents the Executive Director from amending or rescinding all or any of the permit exemptions.
5. Nothing in this declaration exempts the owners or their agents from the responsibility to seek relevant planning or building permits from the responsible authority where applicable.

* All basic refurbishment works including repairs to buildings and structures, where works are documented and administered by a recognised conservation consultant.

* Installation of perimeter fencing.

* Modification and replacement of tracks to the extent of the rails, sleepers and ballast.

* Installation of new landscaping features but excluding earthworks where more than 1m³ of ground is to be altered.

Station Buildings

Exterior

- *Replacement of decayed fabric with fabric that matches the original design and profile.
- * Installation of new but not removal of existing original significant signage.
- * Installation of temporary protective hoardings, screens and the like for the protection against intrusion of vandals and the like provided that no damage is sustained to significant fabric.
- * Installation of new damp proofing and making good to match existing, adjacent surfaces.

Interior

- * Interior painting but not stripping of existing paint scheme.
- * Installation of new but not removal of existing original significant carpets/flexible floor coverings.
- * Installation of new but not removal of existing original significant fixtures and fittings, including clocks, soft furnishings including curtain tracks, rods, blinds and other window dressings, and the like.
- * Installation of new but not the removal of existing original significant signage.
- * Installation of new partitions provided that no damage is sustained to significant fabric.
- * Replacement of non-original kitchen and toilet fixtures provided that no damage is sustained to significant fabric.
- * Installation of insulation to ceiling spaces.
- * Installation of hooks, nails and other devices for the hanging of paintings, mirrors and other wall mounted works of art.

Construction dates	1879,
Architect/Designer	Elsdon, William,
Heritage Act Categories	Registered place,
Hermes Number	555
Property Number	

History

The Gordon Railway Station is historically significant for its associations with the Geelong-Ballarat Line, one of Victoria's first railway lines. The station is rare and intact example of a station building during the 'light lines' era, along one of the 'main trunk' lines. The 'light lines' (c.1869 - 1884) followed the earlier 'main trunk' lines of the 1850s and 1860s. A determined effort was made to minimise the cost of railway construction, due to the previous lavish expenditure on railway structures, and a worldwide financial depression in the late 1860s. This resulted in a more restrained station building design approach, which, in this case, featured timber station buildings where masonry had previously been preferred. (Beeston, 1995)

Extent of Registration

1. All of the buildings known as the Gordon Railway Station, including the station building and associated platform (B1), lamp room (B2), as marked on plan 606786 held by the Executive Director.
2. All of the land surrounding the buildings marked L1 on plan 606786 held by the Executive Director, being part of land described in Certificate of Title Volume 9911, Folio 743.

This place/object may be included in the Victorian Heritage Register pursuant to the Heritage Act 2017. Check the Victorian Heritage Database, selecting 'Heritage Victoria' as the place source.

For further details about Heritage Overlay places, contact the relevant local council or go to Planning Schemes Online <http://planningschemes.dpcd.vic.gov.au/>