

THE HAWTHORNS



THE HAWTHORNS SOHE
2008



THE HAWTHORNS SOHE
2008



1 the Hawthorns Hawthorn
front view jun1978



the Hawthorns Hawthorn
former stables jun1978



h00457 the Hawthorns
Creswick St Hawthorn front
door



h00457 the Hawthorns
Creswick St Hawthorn upper
front window

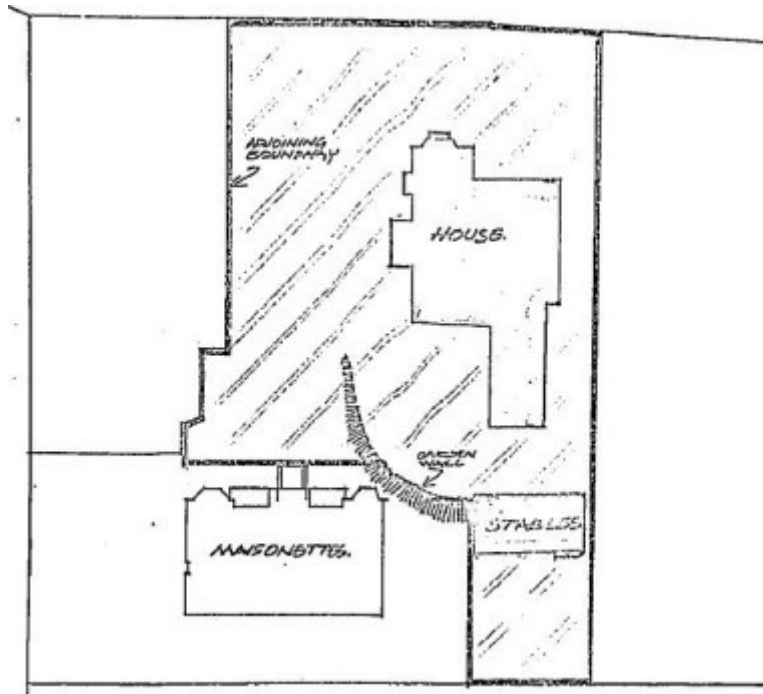

plan h00457

Location

5 CRESWICK STREET HAWTHORN, BOROONDARA CITY

Municipality

BOROONDARA CITY

Level of significance

Registered

Victorian Heritage Register (VHR) Number

H0457

Heritage Overlay Numbers

HO39

VHR Registration

October 3, 1979

Heritage Listing

Victorian Heritage Register

Statement of Significance

Last updated on - April 7, 2021

What is significant?

The Hawthorns, initially known as The Falls, was built in 1845 for James Pinnock. In 1852 the property was subdivided and the house was purchased by Henry Creswick, MLA for Emerald Hill in 1863, who renamed it The Hawthorns. The bluestone house is built in the Gothic Revival style using blackwood and boxwood in the roof frame, cast iron spouting and lead flashings, and retains decorative bargboards.

How is it significant?

The Hawthorns is of historic and architectural significance to the State of Victoria

Why is it significant?

The Hawthorns is historically important through its association with Victoria's settlement and suburban development. It is also historically important in demonstrating the values associated with mid-nineteenth century concepts of residential retreat from the city, which became the suburban ideal. The Hawthorns is important in exhibiting good design and aesthetic characteristics of the Gothic Revival style. The house is also important for representing the characteristics of mid-nineteenth century domestic building material.

Permit Exemptions

General Exemptions:

General exemptions apply to all places and objects included in the Victorian Heritage Register (VHR). General exemptions have been designed to allow everyday activities, maintenance and changes to your property, which

don't harm its cultural heritage significance, to proceed without the need to obtain approvals under the Heritage Act 2017.

Places of worship: In some circumstances, you can alter a place of worship to accommodate religious practices without a permit, but you must **notify** the Executive Director of Heritage Victoria before you start the works or activities at least 20 business days before the works or activities are to commence.

Subdivision/consolidation: Permit exemptions exist for some subdivisions and consolidations. If the subdivision or consolidation is in accordance with a planning permit granted under Part 4 of the *Planning and Environment Act 1987* and the application for the planning permit was referred to the Executive Director of Heritage Victoria as a determining referral authority, a permit is not required.

Specific exemptions may also apply to your registered place or object. If applicable, these are listed below. Specific exemptions are tailored to the conservation and management needs of an individual registered place or object and set out works and activities that are exempt from the requirements of a permit. Specific exemptions prevail if they conflict with general exemptions.

Find out more about heritage permit exemptions [here](#).

Construction dates	1852,
Architect/Designer	Gill, John,
Heritage Act Categories	Registered place,
Hermes Number	575
Property Number	

Extent of Registration

AMENDMENT OF REGISTER OF HISTORIC BUILDINGS

Historic Building No. 457

"The Hawthorns", 5 Creswick Street, Hawthorn, (to the extent of the house, stables, front garden and part of wall, but excluding maisonettes as per attached plan held in the office of the Ministry for Planning.

[*Victoria Government Gazette* No. 81 3 October 1979 p. 3089]

This place/object may be included in the Victorian Heritage Register pursuant to the Heritage Act 2017. Check the Victorian Heritage Database, selecting 'Heritage Victoria' as the place source.

For further details about Heritage Overlay places, contact the relevant local council or go to Planning Schemes Online <http://planningschemes.dpcd.vic.gov.au/>