

POLICE STATION AND FORMER COURT HOUSE



POLICE STATION AND
FORMER COURT HOUSE
SOHE 2008



POLICE STATION AND
FORMER COURT HOUSE
SOHE 2008



POLICE STATION AND
FORMER COURT HOUSE
SOHE 2008



1 police station & former
court house kew front view



police station & former
court house kew detail of
attached pillar



police station & former
court house kew detail of
front window



police station & former
court house kew detail of
tower

EXTENT OF DESIGNATION
Plan 601768H

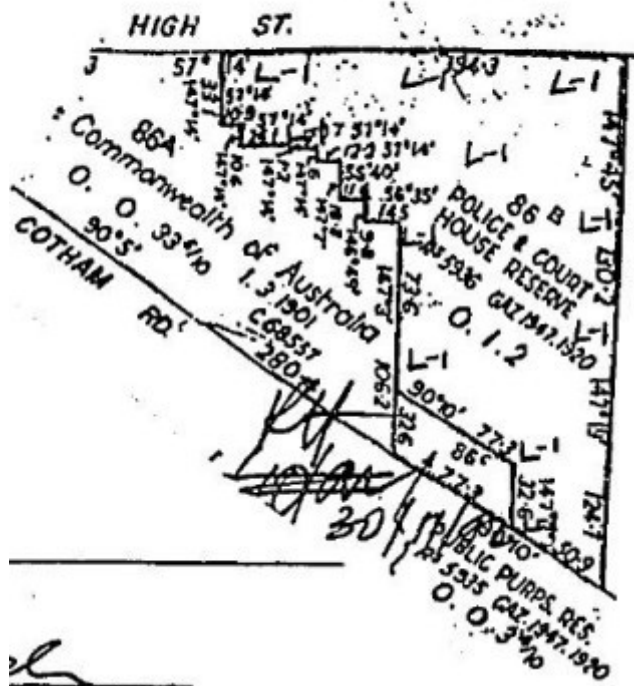

H0944 plan

Location

188 HIGH STREET KEW, BOROONDARA CITY

Municipality

BOROONDARA CITY

Level of significance

Registered

Victorian Heritage Register (VHR) Number

H0944

Heritage Overlay Numbers

HO69

VHR Registration

August 20, 1982

Amendment to Registration

December 16, 1992

Heritage Listing

Victorian Heritage Register

Statement of Significance

Last updated on - February 9, 2000

What is significant?

The former Kew Police Station and former Court House was built as part of a complex constructed to also accommodate a post office. The building was designed in the Queen Anne style by the Public Works Department's architect J Harvey and completed in 1888.

How is it significant?

The former Kew Police Station and former Court House is of historic and architectural significance to the State of Victoria.

Why is it significant?

The former Kew Police Station and former Court House, together with the Kew Post Office, is important because it exhibits diversity in integrating civil offices, and because the design accommodates the apex of road junctions. The former Police Station and Court House is important because it demonstrates a departure from the contemporaneously favoured High Victorian Classical to the Queen Anne style in the design of civic buildings. The former Kew Police Station and former Court House are of historic importance because of its relationship to, and ability to reflect, Melbourne's prosperity in the late nineteenth century; a prosperity which gave rise to the emergence of an upper middle class and the development of Kew as one of Melbourne's wealthier suburbs.

Permit Exemptions

General Exemptions:

General exemptions apply to all places and objects included in the Victorian Heritage Register (VHR). General exemptions have been designed to allow everyday activities, maintenance and changes to your property, which don't harm its cultural heritage significance, to proceed without the need to obtain approvals under the Heritage Act 2017.

Places of worship: In some circumstances, you can alter a place of worship to accommodate religious practices without a permit, but you must **notify** the Executive Director of Heritage Victoria before you start the works or activities at least 20 business days before the works or activities are to commence.

Subdivision/consolidation: Permit exemptions exist for some subdivisions and consolidations. If the subdivision or consolidation is in accordance with a planning permit granted under Part 4 of the *Planning and Environment Act 1987* and the application for the planning permit was referred to the Executive Director of Heritage Victoria as a determining referral authority, a permit is not required.

Specific exemptions may also apply to your registered place or object. If applicable, these are listed below. Specific exemptions are tailored to the conservation and management needs of an individual registered place or object and set out works and activities that are exempt from the requirements of a permit. Specific exemptions prevail if they conflict with general exemptions.

Find out more about heritage permit exemptions [here](#).

Construction dates	1886,
Architect/Designer	Harvey, JH,
Heritage Act Categories	Registered place,
Other Names	Court House and Police Station,
Hermes Number	619
Property Number	

Extent of Registration

AMENDMENT OF REGISTER OF HISTORIC BUILDINGS

Historic Building No. 944.

Police Station and former Court House, High Street, Kew.

(To the extent of:

1. All of the buildings known as Kew Police Station and former Court House with the exception of the brick shed at the rear of the Police Station and the timber extension on the east side of the Police Station.
2. All of the land described in Police and Court House Reserve RS5936 Gazettal 1947.1920, being that land marked L-1 on Plan 601768H, endorsed by the Chairperson, Historic Buildings Council and held by the Director, Historic Buildings Council.)

[Victoria Government Gazette No. G49 16 December 1992 p.3817]

This place/object may be included in the Victorian Heritage Register pursuant to the Heritage Act 2017. Check the Victorian Heritage Database, selecting 'Heritage Victoria' as the place source.

For further details about Heritage Overlay places, contact the relevant local council or go to Planning Schemes Online <http://planningschemes.dpcd.vic.gov.au/>