

FORMER GAS INSPECTOR'S RESIDENCE

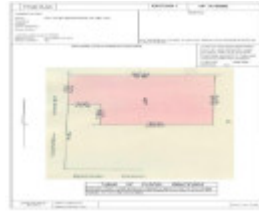

FORMER GAS
INSPECTOR'S RESIDENCE
SOHE 2008



Volume 9060 Folio 071 .JPG

Location

7 GLEADELL STREET RICHMOND, YARRA CITY

Municipality

YARRA CITY

Level of significance

Registered

Victorian Heritage Register (VHR) Number

H1610

Heritage Overlay Numbers

HO260

VHR Registration

May 18, 1988

Amendment to Registration

May 23, 1998

Heritage Listing

Statement of Significance

Last updated on - July 20, 1999

What is significant?

The Former Gas Inspector's Residence at 1 Gleadell Street, Richmond, was built in 1883 for the Metropolitan Gas Company, following the construction of its Richmond gasometer in 1882. The seven-room house was the residence for the company's inspectors, the first of whom to occupy the house was John Corn. It seems to have been occupied as a residence until being sold to the Education Department in 1974. The building is a single storey structure, on a bluestone base, and was built in a style almost identical to the original town hall, post office and police station complex opposite. It was constructed of polychrome brick, symmetrically arranged around a central recessed arched entrance with an arched window on either side. The slate roof and prominent brick chimneys are distinctive features. The building is currently being used by Richmond Secondary College.

How is it significant?

The Former Gas Inspector's Residence is of historical and architectural significance to the State of Victoria.

Why is it Significant?

The Former Gas Inspector's Residence is of historical significance as a remnant of Melbourne's once extensive coal-manufactured gas supply network. The Metropolitan Gas Company built a gasometer in Richmond in 1882 to improve the supply of gas to Richmond and Hawthorn, which were at the time at the outer limits of the system. The residence is all that now remains of the Richmond Gasworks, the gasometer having been demolished in 1959, as was most of the infrastructure for coal-manufactured gas throughout the metropolitan area after the introduction of natural gas in 1969. The survival of the Former Gas Inspector's Residence provides an important association with the Metropolitan Gas Company, once a major supplier of gas to the city, and a reminder of Melbourne's early infrastructure development.

The Former Gas Inspector's Residence is of historical significance as a rare example of on-site industrial accommodation, demonstrating a form of industrial organisation that is very rare today. The form of the building, with its rare recessed porch and kitchen access off the main street, show the restrictions imposed by its location as part of the gasworks complex.

The Former Gas Inspector's Residence is of historical significance as a rare, substantially intact and attractive 19th century industrial residence. While the planning of the residence is traditional, the formality of its exterior and interior, the use of simple classical details and the restrained use of polychrome brick combine to give this small building an impressive dignity.

The exterior of the house is unaltered except for extensions at the rear, which date from soon after the turn of the century, which may have been prompted by the introduction of sewerage at that time. The interior is also largely intact, with surviving decorative details such as fireplaces and mantles, joinery and plasterwork. An interesting comparison can be made with the elaborate old valve house at 617 St Kilda Road, St Kilda. The impressive architecture of these two buildings provides an interesting demonstration of the importance of the infrastructure of gas production in 19th century Melbourne.

Permit Exemptions

General Exemptions:

General exemptions apply to all places and objects included in the Victorian Heritage Register (VHR). General exemptions have been designed to allow everyday activities, maintenance and changes to your property, which don't harm its cultural heritage significance, to proceed without the need to obtain approvals under the Heritage Act 2017.

Places of worship: In some circumstances, you can alter a place of worship to accommodate religious practices without a permit, but you must [notify](#) the Executive Director of Heritage Victoria before you start the works or activities at least 20 business days before the works or activities are to commence.

Subdivision/consolidation: Permit exemptions exist for some subdivisions and consolidations. If the subdivision or consolidation is in accordance with a planning permit granted under Part 4 of the *Planning and Environment Act 1987* and the application for the planning permit was referred to the Executive Director of Heritage Victoria as a determining referral authority, a permit is not required.

Specific exemptions may also apply to your registered place or object. If applicable, these are listed below. Specific exemptions are tailored to the conservation and management needs of an individual registered place or object and set out works and activities that are exempt from the requirements of a permit. Specific exemptions prevail if they conflict with general exemptions.

Find out more about heritage permit exemptions [here](#).

| | |
|-------------------------|-------------------|
| Construction dates | 1883, |
| Heritage Act Categories | Registered place, |
| Hermes Number | 979 |
| Property Number | |

History

Associated People: Tenant JOHN CORN;

Extent of Registration

Amendment of Register of Government Buildings
Former Gas Inspector's Residence, 1 Gleadell Street, Richmond (all of the buildings contained in Certificate of Title Volume 9060 Folio 071).
[*Victoria Government Gazette* No. G39 12 October 1988 p.3093]

Transferred to the Victorian Heritage Register 23 May 1998 (2 years after the proclamation of the Heritage Act 1995 pursuant to the transitional provisions of the Act)

This place/object may be included in the Victorian Heritage Register pursuant to the Heritage Act 2017. Check the Victorian Heritage Database, selecting 'Heritage Victoria' as the place source.

For further details about Heritage Overlay places, contact the relevant local council or go to Planning Schemes Online <http://planningschemes.dpcd.vic.gov.au/>